

# EMAX



TNT MANUFACTURING CO., LTD

# EMAX



TNT MANUFACTURING CO., LTD

NO.483, SEC.1, SANRONG RD., WURI DIST.,  
TAICHUNG CITY, 414, TAIWAN, R.O.C.  
Tel: 886-4-2336-3668 Fax: 886-4-2310-3706

[www.emaxtaiwan.com](http://www.emaxtaiwan.com)



2014.2000

## PROFESSIONAL PNEUMATIC TOOL

TUV CE ISO 9001-2000

**EMAX / TNT Manufacturing Co., Ltd is a leading manufacturer, supplier & exporter specializing in high quality professional pneumatic tools & accessories, with a factory in Taiwan & a complete range of quality Air compressors, with factories in China & Taiwan.**

**EMAX/ TNT is an innovative company.**

**As a result of constant research and investment, we keep at the forefront of current technology and design, thus providing energy efficient, durable and reliable products to Automotive & industrial markets around the world.**

**EMAX, PARTNERS IN BUSINESS.**

|                       |    |
|-----------------------|----|
| <b>IMPACT WRENCH</b>  | 2  |
| <b>RATCHET WRENCH</b> | 12 |
| <b>IMPACT SOCKET</b>  | 14 |
| <b>DRILL</b>          | 18 |

|                      |    |
|----------------------|----|
| <b>ANGLE GRINDER</b> | 21 |
| <b>DIE GRINDER</b>   | 22 |
| <b>AUTO BODY</b>     | 26 |

|                      |    |
|----------------------|----|
| <b>NEEDLE SCALER</b> | 31 |
| <b>SANDER</b>        | 32 |
| <b>HAMMER</b>        | 36 |
| <b>CHISEL</b>        | 40 |
| <b>RIVETER</b>       | 44 |
| <b>SCREWDRIVER</b>   | 46 |

|                          |    |
|--------------------------|----|
| <b>HOSE REEL</b>         | 48 |
| <b>AIR CONTROL UNITS</b> | 49 |
| <b>SPRING BALANCER</b>   | 50 |
| <b>BLOW GUN</b>          | 51 |
| <b>SPRAY GUN</b>         | 54 |
| <b>BRUSH KIT</b>         | 55 |
| <b>MINI COMPRESSOR</b>   | 56 |
| <b>COMPRESSOR</b>        | 57 |
| <b>QUICK COUPLER</b>     | 58 |
| <b>FRAMING NAILER</b>    | 60 |
| <b>COIL NAILER</b>       | 61 |
| <b>TOOL KIT</b>          | 62 |
| <b>CORDLESS TOOL</b>     | 65 |





## The introduction of hammer mechanism

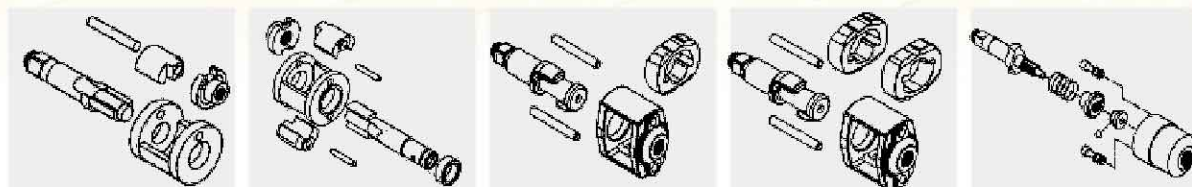

- A. Common design by single hammer, it's recommended for D.I.Y end user
- B. Stable torque and low vibration, it's recommended for assembly line of factory and ordinary repair work
- C. New hammer cage design by powerful single hammer, it's recommended for amateur user and mechanic of workshop
- D. New hammer cage design by powerful twin hammers, it's recommended for professional expert and mechanic of workshop
- E. Smooth torque and lower vibration than two hammer type, it's recommended for assembly line of factory and mechanic of workshop



Twin hammer impact mechanism to perform best torque output, and Special Hardened-Treatment to maintain best durability.

Special Hardened-Treated Cylinder, Front plate and Rear plate to generate best durability.



3 different speed adjustment at Forward direction, 1 full speed at Reverse direction.



Titanium clutch case to re-enforce the strength (AT-5140T).



Vane with spring mounted to prevent dead-lock or power-less problem.

Composite handle to provide best power-to-weight ratio, and prevent uncomfortable usage during the temperature change.

360 degree swivel air inlet to prevent air hose twisted.



**AT-5140**  
1/2" DR. Composite Impact Wrench  
- TWIN HAMMER  
- WORKING TORQUE: 880Nm(650ft-lb)/5S  
- MAX TORQUE: 1112Nm(820ft-lb)/15S



**AT-5140-2**  
1/2" DR. Impact Wrench W/2" Anvil  
- TWIN HAMMER  
- WORKING TORQUE: 827Nm(610ft-lb)/5S  
- MAX TORQUE: 1053Nm(780ft-lb)/15S



**AT-5160**  
3/4" DR. Mini Impact Wrench  
- TWIN HAMMER  
- WORKING TORQUE: 880Nm(650ft-lb)/5S  
- MAX TORQUE: 1112Nm(820ft-lb)/15S



**AT-5140T**  
1/2" DR. Titanium Composite Impact Wrench  
- TWIN HAMMER / TITANIUM HAMMER CASE  
- WORKING TORQUE: 880Nm(650ft-lb)/5S  
- MAX TORQUE: 1112Nm(820ft-lb)/15S



**AT-5140N**  
1/2" DR. Torque Limited Impact Wrench  
- TWIN HAMMER  
- MAX FORWARD TORQUE: 90Nm(65ft-lb)  
- MAX REVERSE TORQUE: 880Nm(642ft-lb)



**AT-1045**  
3/4" DR. Composite Impact Wrench  
- TWIN HAMMER  
- WORKING TORQUE: 1763Nm(1300ft-lb)/5S  
- MAX TORQUE: 2337Nm(1650ft-lb)/15S

| Model No. | Square Drive | Free Speed RPM | Max Torque |      | Overall Length |     | Air Inlet (PT) | Air Hose (ID) | Avg-Air Cons. |       | Net Weight |      | Packing Pcs/Ctn/G.W./Cuft (kgs) |
|-----------|--------------|----------------|------------|------|----------------|-----|----------------|---------------|---------------|-------|------------|------|---------------------------------|
|           |              |                | ft-lb      | n-m  | in.            | mm  |                |               | CFM           | l/min | lbs        | kgs. |                                 |
| AT-5140   | 1/2"         | 8,500          | 820        | 1112 | 7 2/5"         | 190 | 1/4"           | 3/8"          | 4.9           | 138.8 | 4.6        | 2.1  | 10Ctn/24.5/1.6'                 |
| AT-5140-2 | 1/2"         | 8,500          | 780        | 1053 | 9 2/5"         | 240 | 1/4"           | 3/8"          | 4.9           | 138.8 | 5          | 2.3  | 10Ctn/24.5/1.6'                 |
| AT-5160   | 3/4"         | 8,500          | 820        | 1112 | 7 3/5"         | 195 | 1/4"           | 3/8"          | 4.9           | 138.8 | 5          | 2.3  | 10Ctn/24.5/1.6'                 |
| AT-5140T  | 1/2"         | 8,500          | 820        | 1112 | 7 2/5"         | 190 | 1/4"           | 3/8"          | 4.9           | 138.8 | 4.8        | 2.2  | 10Ctn/24.5/1.6'                 |
| AT-1045   | 3/4"         | 5,500          | 1650       | 2337 | 8 3/5"         | 220 | 3/8"           | 1/2"          | 11            | 300   | 8.1        | 3.7  | 6Ctn/24.6/1.3'                  |

| Model No. | Square Drive | Free Speed RPM | Max Torque   |              | Overall Length |     | Air Inlet (PT) | Air Hose (ID) | Avg-Air Cons. |       | Net Weight |      | Packing Pcs/Ctn/G.W./Cuft (kgs) |
|-----------|--------------|----------------|--------------|--------------|----------------|-----|----------------|---------------|---------------|-------|------------|------|---------------------------------|
|           |              |                | forward (nm) | reverse (nm) | in.            | mm  |                |               | CFM           | l/min | lbs        | kgs. |                                 |
| AT-5140N  | 1/2"         | 8,500          | 90           | 880          | 7 2/5"         | 190 | 1/4"           | 3/8"          | 4.9           | 138.8 | 4.6        | 2.1  | 10Ctn/24.5/1.6'                 |

1/2" & 3/4" IMPACT WRENCH

1/2" & 3/4" IMPACT WRENCH



3/8" & 1/2" IMPACT WRENCH

3/8" & 1/2" IMPACT WRENCH



**AT-1351**  
3/8"DR. Impact Wrench

- TWIN HAMMER / COMPOSITE HOUSING  
- MAX TORQUE: 379 Nm ( 280ft-lb)



**AT-1063A**  
3/8"DR. Impact Wrench

- TWIN HAMMER / COMPOSITE HOUSING  
- MAX TORQUE: 298 Nm ( 220ft-lb)



**AT-5030**  
3/8"DR. Butterfly Impact Wrench

- ROCKING CLUTCH  
- MAX TORQUE: 102 Nm( 75ft-lb)



**AT-5036**  
3/8"DR. Impact Wrench

- PIN CLUTCH  
- MAX TORQUE: 298 Nm(220ft-lb)

**AT-1355**  
1/2"DR. Impact Wrench

**AT-2860A**  
1/2"DR. Impact Wrench

- MAX TORQUE: 1288Nm (950ft-lb)

**AT-2050A**  
3/8"DR. Mini Impact Wrench

- TWIN HAMMER  
- MAX TORQUE: 542 Nm( 400ft-lb)

**AT-1369**  
3/8"DR. S.D. Impact Wrench

- JUMBO CLUTCH  
- MAX TORQUE: 407 Nm( 300ft-lb)



**AT-3020W**  
3/8"DR. In-Line Impact Wrench

- TWO HAMMER  
- MAX TORQUE: 70 Nm( 52ft-lb)

**AT-2050B**  
1/2"DR. Mini Impact Wrench

**AT-1469**  
1/2"DR. S.D. Impact Wrench

**AT-5029**  
3/8"DR. Impact Wrench

- JUMBO CLUTCH  
- MAX TORQUE: 271 Nm( 200ft-lb)

**AT-5031**  
3/8"DR. Impact Wrench

- ROCKING CLUTCH  
- MAX TORQUE: 257 Nm( 190ft-lb)



**AT-5029A**  
1/2"DR. Impact Wrench

**AT-5031A**  
1/2"DR. Impact Wrench



**AT-3010JW**  
3/8"DR. In-Line Impact Wrench

- JUMBO CLUTCH  
- MAX TORQUE: 100 Nm( 74ft-lb)



**AT-3040W**  
3/8"DR. Corner Impact Wrench

- TWO HAMMER/ 90°ANGLE HEAD  
- MAX TORQUE: 65 Nm( 48ft-lb)

| Model No. | Square Drive | Free Speed RPM | Max Torque |      | Overall Length |     | Air Inlet (PT) | Air Hose (ID) | Avg-Air Cons. |       | Net Weight |      | Packing Pcs/Ctn/G.W./Cuft (kgs) |
|-----------|--------------|----------------|------------|------|----------------|-----|----------------|---------------|---------------|-------|------------|------|---------------------------------|
|           |              |                | ft-lb      | n-m  | in.            | mm  |                |               | CFM           | l/min | lbs        | kgs. |                                 |
| AT-1351   | 3/8"         | 10,000         | 280        | 379  | 5 5/8"         | 143 | 1/4"           | 3/8"          | 4.0           | 113.0 | 2.9        | 1.3  | 12/Ctn/16/1.24'                 |
| AT-1355   | 1/2"         | 10,000         | 280        | 379  | 5 5/8"         | 143 | 1/4"           | 3/8"          | 4.0           | 113.0 | 2.9        | 1.3  | 12/Ctn/16/1.24'                 |
| AT-1063A  | 3/8"         | 10,000         | 220        | 298  | 6 1/2"         | 165 | 1/4"           | 3/8"          | 5.0           | 142.0 | 2.9        | 1.3  | 10/Ctn/14/1.10'                 |
| AT-2860A  | 1/2"         | 7,500          | 950        | 1288 | 7 4/5"         | 198 | 1/4"           | 3/8"          | 7.0           | 198.0 | 4.4        | 2.0  | 10/Ctn/25/1.50'                 |
| AT-2050A  | 3/8"         | 12,000         | 400        | 542  | 5 5/8"         | 145 | 1/4"           | 3/8"          | 5.6           | 159.0 | 3.5        | 1.6  | 10/Ctn/18/0.83'                 |
| AT-2050B  | 1/2"         | 12,000         | 400        | 542  | 5 5/8"         | 145 | 1/4"           | 3/8"          | 5.6           | 159.0 | 3.5        | 1.6  | 10/Ctn/18/0.83'                 |
| AT-1369   | 3/8"         | 6,500          | 300        | 407  | 4 1/2"         | 116 | 1/4"           | 3/8"          | 2.7           | 71.0  | 3.4        | 1.5  | 12/Ctn/21.1/0.95'               |
| AT-1469   | 1/2"         | 10,000         | 500        | 678  | 4 1/2"         | 116 | 1/4"           | 3/8"          | 4.7           | 133.0 | 3.4        | 1.5  | 12/Ctn/21.1/0.95'               |
| AT-5029   | 3/8"         | 10,000         | 200        | 271  | 5 1/2"         | 140 | 1/4"           | 3/8"          | 2.5           | 71.0  | 2.9        | 1.3  | 12/Ctn/19.5/1.24'               |
| AT-5029A  | 1/2"         | 10,000         | 200        | 271  | 5 1/2"         | 140 | 1/4"           | 3/8"          | 2.5           | 71.0  | 2.9        | 1.3  | 12/Ctn/19.5/1.24'               |
| AT-5031   | 3/8"         | 9,000          | 190        | 257  | 5 7/8"         | 149 | 1/4"           | 3/8"          | 3.0           | 85.0  | 3.0        | 1.4  | 10/Ctn/16.0/1.22'               |
| AT-5031A  | 1/2"         | 9,000          | 190        | 257  | 5 7/8"         | 149 | 1/4"           | 3/8"          | 3.0           | 85.0  | 3.0        | 1.4  | 10/Ctn/16.0/1.22'               |

| Model No. | Square Drive | Free Speed RPM | Max Torque |     | Overall Length |     | Air Inlet (PT) | Air Hose (ID) | Avg-Air Cons. |       | Net Weight |      | Packing Pcs/Ctn/G.W./Cuft (kgs) |
|-----------|--------------|----------------|------------|-----|----------------|-----|----------------|---------------|---------------|-------|------------|------|---------------------------------|
|           |              |                | ft-lb      | n-m | in.            | mm  |                |               | CFM           | l/min | lbs        | kgs. |                                 |
| AT-5030   | 3/8"         | 10,000         | 75         | 102 | 5 1/2"         | 140 | 1/4"           | 3/8"          | 5.0           | 142.0 | 2.6        | 1.3  | 20/Ctn/20.0/0.7'                |
| AT-5036   | 3/8"         | 9,000          | 220        | 298 | 6 1/2"         | 165 | 1/4"           | 3/8"          | 4.2           | 119.0 | 3.3        | 1.5  | 10/Ctn/18/1.22'                 |
| AT-3020W  | 3/8"         | 8,000          | 52         | 70  | 7 1/2"         | 190 | 1/4"           | 3/8"          | 5.6           | 159.0 | 2.2        | 1.0  | 20/Ctn/23.5/1.4'                |
| AT-3010JW | 3/8"         | 8,000          | 74         | 100 | 8 1/3"         | 210 | 1/4"           | 3/8"          | 4.6           | 130.0 | 2.6        | 1.3  | 20/Ctn/18.3/0.91'               |
| AT-3040W  | 3/8"         | 8,000          | 48         | 65  | 8 1/2"         | 217 | 1/4"           | 3/8"          | 5.6           | 159.0 | 2.6        | 1.3  | 20/Ctn/18.3/0.91'               |



1/2" IMPACT WRENCH

1/2" IMPACT WRENCH

**TITANIUM HAMMER CASE**



**AT-1063**  
1/2"DR. Impact Wrench  
- TWIN HAMMER / COMPOSITE HOUSING  
- MAX TORQUE: 1112Nm (820ft-lb)



**AT-1454**  
1/2"DR. Impact Wrench  
- TWIN HAMMER / COMPOSITE HOUSING  
- MAX TORQUE: 814Nm (600ft-lb)



**AT-3260A**  
1/2"DR. Impact Wrench  
- TWIN HAMMER / COMPOSITE HOUSING  
- MAX TORQUE: 1288Nm (950ft-lb)



**AT-5042**  
1/2"DR. Impact Wrench  
- PIN CLUTCH / RUBBER HANDLE  
- MAX TORQUE: 542Nm (400ft-lb)



**AT-1064**  
3/8"DR. Impact Wrench  
- TWIN HAMMER / COMPOSITE HOUSING  
- MAX TORQUE: 678Nm (500ft-lb)



**AT-1015**  
1/2"DR. Impact Wrench  
- TWIN HAMMER / COMPOSITE HOUSING  
- MAX TORQUE: 1112Nm (820ft-lb)



**AT-5044**  
1/2"DR. Impact Wrench  
- TWIN HAMMER  
- MAX TORQUE: 542Nm (400ft-lb)



**AT-5044B**  
1/2"DR. Impact Wrench  
- TWIN HAMMER  
- MAX TORQUE: 746Nm (550ft-lb)



**AT-2030S**  
1/2"DR. Impact Wrench  
- TWIN HAMMER  
- MAX TORQUE: 759Nm (560ft-lb)



**AT-1260**  
1/2"DR. Impact Wrench  
- TWIN HAMMER / RUBBER HANDLE  
- MAX TORQUE: 576Nm (425ft-lb)



**AT-5047A**  
1/2"DR. Impact Wrench  
- TWIN HAMMER / RUBBER HANDLE  
- MAX TORQUE: 1071Nm (790ft-lb)



**AT-1480**  
1/2"DR. Heavy Duty Impact Wrench  
- TWIN HAMMER / COMPOSITE HOUSING  
- MAX TORQUE: 1085Nm (800ft-lb)

**AT-2030L**  
1/2"DR. Impact Wrench  
- W/2" EXTENDED ANVIL  
- MAX TORQUE: 753Nm (555ft-lb)

**AT-1681**  
3/4"DR. Mini Type Impact Wrench  
- MAX TORQUE: 1085Nm (800ft-lb)

| Model No. | Square Drive | Free Speed RPM | Max Torque |      | Overall Length |     | Air Inlet (PT) | Air Hose (ID) | Avg-Air Cons. |       | Net Weight |      | Packing Pcs/Ctn/G.W./Cuft (kgs) |
|-----------|--------------|----------------|------------|------|----------------|-----|----------------|---------------|---------------|-------|------------|------|---------------------------------|
|           |              |                | ft-lb      | n-m  | in.            | mm  |                |               | CFM           | l/min | lbs        | kgs. |                                 |
| AT-1063   | 1/2"         | 8,500          | 820        | 1112 | 7 1/2"         | 190 | 1/4"           | 3/8"          | 4.9           | 138.8 | 4.8        | 2.2  | 10/Ctn/25.5/1.6'                |
| AT-1454   | 1/2"         | 8,000          | 600        | 814  | 7 5/8"         | 193 | 1/4"           | 3/8"          | 4.4           | 125.0 | 4.7        | 2.2  | 8/Ctn/19.3/1.3'                 |
| AT-1064   | 3/8"         | 8,000          | 500        | 678  | 6 1/3"         | 160 | 1/4"           | 3/8"          | 5.0           | 142.0 | 2.9        | 1.3  | 10/Ctn/15.3/0.9'                |
| AT-1079   | 1/2"         | 11,000         | 550        | 745  | 6 1/3"         | 160 | 1/4"           | 3/8"          | 5.0           | 142.0 | 2.9        | 1.3  | 10/Ctn/15.7/0.9'                |
| AT-1015   | 1/2"         | 8,500          | 820        | 1112 | 7 1/2"         | 190 | 1/4"           | 3/8"          | 4.9           | 138.8 | 4.6        | 2.1  | 10/Ctn/24.5/1.6'                |
| AT-2030S  | 1/2"         | 8,000          | 560        | 759  | 7 1/4"         | 185 | 1/4"           | 3/8"          | 7.1           | 201.0 | 5.7        | 2.6  | 8/Ctn/23.5/1.2'                 |
| AT-2030L  | 1/2"         | 8,000          | 555        | 753  | 9 1/4"         | 235 | 1/4"           | 3/8"          | 7.1           | 201.0 | 5.9        | 2.7  | 8/Ctn/25.0/1.4'                 |
| AT-1260   | 1/2"         | 7,700          | 425        | 576  | 7 5/16"        | 187 | 1/4"           | 3/8"          | 7.0           | 198.0 | 5.6        | 2.6  | 10/Ctn/26.0/1.7'                |

| Model No. | Square Drive | Free Speed RPM | Max Torque |      | Overall Length |     | Air Inlet (PT) | Air Hose (ID) | Avg-Air Cons. |       | Net Weight |      | Packing Pcs/Ctn/G.W./Cuft (kgs) |
|-----------|--------------|----------------|------------|------|----------------|-----|----------------|---------------|---------------|-------|------------|------|---------------------------------|
|           |              |                | ft-lb      | n-m  | in.            | mm  |                |               | CFM           | l/min | lbs        | kgs. |                                 |
| AT-3260A  | 1/2"         | 8,800          | 950        | 1288 | 6 6/8"         | 170 | 1/4"           | 3/8"          | 5.0           | 142.0 | 4.6        | 2.1  | 10/Ctn/23.0/1.6'                |
| AT-3260B  | 3/4"         | 8,800          | 1050       | 1428 | 6 7/8"         | 174 | 1/4"           | 3/8"          | 5.0           | 142.0 | 4.8        | 2.2  | 10/Ctn/23.0/1.6'                |
| AT-5042   | 1/2"         | 6,000          | 400        | 542  | 7 7/8"         | 200 | 1/4"           | 3/8"          | 4.5           | 127.0 | 4.6        | 2.1  | 6/Ctn/15.0/0.9'                 |
| AT-5044   | 1/2"         | 7,000          | 400        | 542  | 5 5/8"         | 146 | 1/4"           | 3/8"          | 7.0           | 198.0 | 5.5        | 2.5  | 8/Ctn/23.0/1.2'                 |
| AT-5044B  | 1/2"         | 7,000          | 550        | 746  | 5 5/8"         | 146 | 1/4"           | 3/8"          | 7.0           | 198.0 | 5.5        | 2.5  | 10/Ctn/27.0/1.6'                |
| AT-5047A  | 1/2"         | 5,000          | 790        | 1071 | 8"             | 205 | 1/4"           | 3/8"          | 4.5           | 127.0 | 5.3        | 2.2  | 10/Ctn/23.0/1.2'                |
| AT-1480   | 1/2"         | 8,000          | 800        | 1085 | 7 7/8"         | 197 | 1/4"           | 3/8"          | 6.7           | 190.0 | 5.07       | 2.3  | 10/Ctn/23.0/1.2'                |
| AT-1681   | 3/4"         | 8,000          | 800        | 1085 | 8 1/2"         | 211 | 1/4"           | 3/8"          | 6.7           | 190.0 | 5.27       | 2.4  | 10/Ctn/24.0/1.2'                |



3/4" & 1" IMPACT WRENCH

3/4" & 1" IMPACT WRENCH

**AT-1636**  
3/4"DR. Impact Wrench

- TWIN HAMMER / COMPOSITE HOUSING
- MAX TORQUE: 1627Nm (1200ft-lb)



**AT-6661A**  
3/4"DR. Impact Wrench

- TWIN HAMMER / COMPOSITE HOUSING
- MAX TORQUE: 1492Nm (1100ft-lb)



**AT-2066**  
3/4"DR. Impact Wrench

- TWIN HAMMER
- MAX TORQUE: 1898Nm (1400ft-lb)



**AT-2066-6**  
3/4"DR. Impact Wrench

- W/ 6" EXTENDED ANVIL
- MAX TORQUE: 1763Nm (1300ft-lb)

**AT-2068**  
1"DR. Impact Wrench

- MAX TORQUE: 1898Nm (1400ft-lb)

**AT-2068-6**  
1"DR. Impact Wrench

- W/ 6" EXTENDED ANVIL
- MAX TORQUE: 1763Nm (1300ft-lb)



**AT-2086**  
3/4"DR. Impact Wrench

- TWIN HAMMER
- MAX TORQUE: 1492Nm (1100ft-lb)



**AT-5060**  
3/4"DR. Impact Wrench

- ROCKING CLUTCH
- MAX TORQUE: 678Nm (500ft-lb)



**AT-5065**  
3/4"DR. Impact Wrench

- PIN CLUTCH
- MAX TORQUE: 949Nm (700ft-lb)



**AT-5066**  
3/4"DR. Impact Wrench

- TWIN HAMMER
- MAX TORQUE: 1017Nm (750ft-lb)



**AT-6082P**  
1"DR. Impact Wrench

- ROCKING CLUTCH
- MAX TORQUE: 1898Nm (1400ft-lb)



**AT-6082P-8**  
1"DR. Impact Wrench

- W/ 8" EXTENDED ANVIL
- MAX TORQUE: 1763Nm (1300ft-lb)

**AT-6087P**  
1"DR. Impact Wrench

- ROCKING CLUTCH
- MAX TORQUE: 1763Nm (1300ft-lb)



**AT-6087P-6**  
1"DR. Impact Wrench

- W/ 6" EXTENDED ANVIL
- MAX TORQUE: 1627Nm (1200ft-lb)

**AT-5067B**  
3/4"DR. Impact Wrench

- TWIN HAMMER
- MAX TORQUE: 2034Nm (1500ft-lb)



**AT-6067B**  
1"DR. Impact Wrench

- MAX TORQUE: 2034Nm (1500ft-lb)

**AT-6083P**  
1"DR. Impact Wrench

- TWIN HAMMER
- MAX TORQUE: 2441Nm (1800ft-lb)



**AT-6083P-8**  
1"DR. Impact Wrench

- W/ 8" EXTENDED ANVIL
- MAX TORQUE: 2305Nm (1700ft-lb)

**AT-6962**  
1"DR. Impact Wrench

- TWIN HAMMER
- MAX TORQUE: 2034Nm (1500ft-lb)



**AT-6962-6**  
1"DR. Impact Wrench

- W/ 6" EXTENDED ANVIL
- MAX TORQUE: 1898Nm (1400ft-lb)

| Model No. | Square Drive | Free Speed RPM | Max Torque |       | Overall Length |     | Air Inlet (PT) | Air Hose (ID) | Avg. Air Cons. |       | Net Weight |      | Packing Pcs/Ctn/G.W./Cuft (kgs) |
|-----------|--------------|----------------|------------|-------|----------------|-----|----------------|---------------|----------------|-------|------------|------|---------------------------------|
|           |              |                | ft-lb      | n-m   | in.            | mm  |                |               | CFM            | l/min | lbs        | kgs. |                                 |
| AT-1636   | 3/4"         | 6,500          | 1,200      | 1,627 | 8 7/8"         | 225 | 3/8"           | 1/2"          | 6.7            | 190.0 | 8.6        | 3.9  | 4/Ctn/20.7/1.24'                |
| AT-6661A  | 3/4"         | 4,500          | 1,100      | 1,492 | 9 1/2"         | 240 | 3/8"           | 1/2"          | 9.7            | 275.0 | 8.4        | 3.8  | 4/Ctn/21.0/1.7'                 |
| AT-2066   | 3/4"         | 7,500          | 1,400      | 1,898 | 8 1/4"         | 210 | 3/8"           | 1/2"          | 10.6           | 300.0 | 9.2        | 4.2  | 6/Ctn/28.2/1.5'                 |
| AT-2066-6 | 3/4"         | 7,500          | 1,300      | 1,763 | 14 1/8"        | 359 | 3/8"           | 1/2"          | 10.6           | 300.0 | 10.3       | 4.7  | 4/Ctn/22.0/1.5'                 |
| AT-2068   | 1"           | 7,500          | 1,400      | 1,898 | 8 1/4"         | 210 | 3/8"           | 1/2"          | 10.6           | 300.0 | 9.2        | 4.2  | 6/Ctn/28.3/1.5'                 |
| AT-2068-6 | 1"           | 7,500          | 1,300      | 1,763 | 14 1/2"        | 360 | 3/8"           | 1/2"          | 10.6           | 300.0 | 11.0       | 5.0  | 4/Ctn/23.5/1.5'                 |
| AT-2086   | 3/4"         | 7,500          | 1,100      | 1,492 | 7"             | 178 | 3/8"           | 1/2"          | 7.8            | 220.0 | 5.9        | 2.7  | 8/Ctn/24.2/1.3'                 |
| AT-5060   | 3/4"         | 4,500          | 500        | 678   | 9 1/2"         | 241 | 1/4"           | 3/8"          | 7.5            | 212.0 | 10.6       | 4.6  | 6/Ctn/30.0/1.85'                |
| AT-5065   | 3/4"         | 4,800          | 700        | 949   | 9 3/4"         | 247 | 1/4"           | 3/8"          | 7.2            | 204.0 | 10.8       | 4.9  | 4/Ctn/22.3/1.23'                |

| Model No.  | Square Drive | Free Speed RPM | Max Torque |       | Overall Length |     | Air Inlet (PT) | Air Hose (ID) | Avg. Air Cons. |       | Net Weight |      | Packing Pcs/Ctn/G.W./Cuft (kgs) |
|------------|--------------|----------------|------------|-------|----------------|-----|----------------|---------------|----------------|-------|------------|------|---------------------------------|
|            |              |                | ft-lb      | n-m   | in.            | mm  |                |               | CFM            | l/min | lbs        | kgs. |                                 |
| AT-5066    | 3/4"         | 6,500          | 750        | 1,017 | 9 2/7"         | 236 | 1/4"           | 3/8"          | 7.0            | 198.0 | 10.0       | 4.6  | 4/Ctn/20.7/1.24'                |
| AT-5067B   | 3/4"         | 5,100          | 1,500      | 2,034 | 8 1/2"         | 215 | 3/8"           | 1/2"          | 8.4            | 238.0 | 11.22      | 5.1  | 4/Ctn/22.6/1.15'                |
| AT-6067B   | 1"           | 5,100          | 1,500      | 2,034 | 8 1/2"         | 215 | 3/8"           | 1/2"          | 8.4            | 238.0 | 11.68      | 5.3  | 4/Ctn/23.4/1.15'                |
| AT-6082P   | 1"           | 3,500          | 1,400      | 1,898 | 11 4/5"        | 300 | 1/2"           | 1/2"          | 11.0           | 312.0 | 21.0       | 9.6  | 2/Ctn/21.6/1.35'                |
| AT-6082P-8 | 1"           | 3,500          | 1,300      | 1,763 | 17 4/5"        | 452 | 1/2"           | 1/2"          | 11.0           | 312.0 | 22.9       | 10.4 | 2/Ctn/28.0/1.88'                |
| AT-6083P   | 1"           | 3,500          | 1,800      | 2,441 | 11 4/5"        | 300 | 1/2"           | 1/2"          | 11.0           | 312.0 | 21.0       | 9.6  | 2/Ctn/22.0/1.35'                |
| AT-6083P-8 | 1"           | 3,500          | 1,700      | 2,305 | 17 4/5"        | 452 | 1/2"           | 1/2"          | 11.0           | 312.0 | 22.9       | 10.4 | 2/Ctn/24.0/1.88'                |
| AT-6087P   | 1"           | 3,000          | 1,300      | 1,763 | 11 1/8"        | 282 | 1/2"           | 1/2"          | 7.0            | 198.0 | 21.0       | 9.5  | 2/Ctn/20.0/1.10'                |
| AT-6087P-6 | 1"           | 3,000          | 1,200      | 1,627 | 15 1/8"        | 384 | 1/2"           | 1/2"          | 7.0            | 198.0 | 23.1       | 10.5 | 2/Ctn/22.0/1.15'                |
| AT-6962    | 1"           | 3,500          | 1,500      | 2,034 | 10 3/5"        | 270 | 1/2"           | 1/2"          | 14.7           | 416.0 | 14.3       | 6.5  | 4/Ctn/28.0/1.20'                |
| AT-6962-6  | 1"           | 3,500          | 1,400      | 1,898 | 14 1/8"        | 360 | 1/2"           | 1/2"          | 14.7           | 416.0 | 16.0       | 7.3  | 4/Ctn/31.0/1.80'                |



1" & 1 1/2" IMPACT WRENCH

1" & 1 1/2" IMPACT WRENCH

**AT-1838P**  
1"DR. Impact Wrench

- TWIN HAMMER (COMPOSITE HOUSING)
- MAX TORQUE: 2,441Nm (1,800ft-lb)



**AT-1838P-6**  
1"DR. Impact Wrench

- W/ 6" EXTENDED ANVIL
- MAX TORQUE: 2,305Nm (1,700ft-lb)

**AT-3804T**  
1"DR. Impact Wrench

- TWIN HAMMER
- W/7" EXTENDED ANVIL
- MAX TORQUE: 2,441Nm (1,800ft-lb)



**AT-6562C**  
1"DR. Impact Wrench

- TWIN HAMMER
- MAX TORQUE: 2,712Nm (2,000ft-lb)

**AT-6562B**  
1"DR. Impact Wrench

- W/ 6" EXTENDED ANVIL
- MAX TORQUE: 2,576Nm (1,900ft-lb)

**AT-6562A**  
1"DR. Impact Wrench

- W/ 8" EXTENDED ANVIL
- MAX TORQUE: 2,576Nm (1,900ft-lb)



**AT-6088P**  
1"DR. Impact Wrench

- PIN CLUTCH
- MAX TORQUE: 2,441Nm (1,800ft-lb)



**AT-6088P-6**  
1"DR. Impact Wrench

- W/ 6" EXTENDED ANVIL
- MAX TORQUE: 2,305Nm (1,700ft-lb)

**AT-2106**  
3/4"DR. Light Impact Wrench

**AT-2108**  
1"DR. Light Impact Wrench

**AT-2106L**  
3/4"DR. Light Impact Wrench

- W/6" EXTENDED ANVIL

**AT-2108L**  
1"DR. Light Impact Wrench

- W/6" EXTENDED ANVIL



**AT-3886T**  
1"DR. Impact Wrench

- TWIN HAMMER
- W/8" EXTENDED ANVIL
- MAX TORQUE: 2,441Nm (1,800ft-lb)



**AT-6082**  
1"DR. HD. Impact Wrench

- ROCKING CLUTCH
- MAX TORQUE: 2441Nm (1800ft-lb)



**AT-6082-8**  
1"DR. HD. Impact Wrench

- W/8" EXTENDED ANVIL
- MAX TORQUE: 2305Nm (1700ft-lb)

**AT-6089B-6**  
1"DR. HD. Impact Wrench

- TWIN HAMMER
- W/6" EXTENDED ANVIL
- MAX TORQUE: 2983Nm (2200ft-lb)



**AT-6086-8**  
1"DR. Impact Wrench

- PIN CLUTCH
- W/8" EXTENDED ANVIL
- MAX TORQUE: 3390Nm (2500ft-lb)



**AT-6090**  
1"DR. HD. Impact Wrench

- TWIN HAMMER / TORQUE: 2100ft-lb
- MAX TORQUE: 2848Nm (2100ft-lb)



**AT-6090-6**  
1"DR. HD. Impact Wrench

- W/6" EXTENDED ANVIL
- MAX TORQUE: 2712Nm (2000ft-lb)

**AT-6090-8**  
1"DR. HD. Impact Wrench

- W/8" EXTENDED ANVIL
- MAX TORQUE: 2712Nm (2000ft-lb)

**AT-6088**  
1"DR. HD. Impact Wrench

- PIN CLUTCH
- MAX TORQUE: 2441Nm (1800ft-lb)



**AT-6088-6**  
1"DR. HD. Impact Wrench

- W/6" EXTENDED ANVIL
- MAX TORQUE: 2305Nm (1700ft-lb)

**AT-6762B**  
1"DR. HD. Impact Wrench

- TWIN HAMMER
- MAX TORQUE: 3390Nm (2500ft-lb)

**AT-6762B-6**  
1"DR. HD. Impact Wrench

- W/6" EXTENDED ANVIL
- MAX TORQUE: 3254Nm (2400ft-lb)

**AT-6762B-8**  
1"DR. HD. Impact Wrench

- W/8" EXTENDED ANVIL
- MAX TORQUE: 3254Nm (2400ft-lb)



**AT-6088B**  
1 1/2"DR. HD. Impact Wrench

- TWIN HAMMER
- MAX TORQUE: 3254Nm (2400ft-lb)



**AT-6088B-8**  
1 1/2"DR. HD. Impact Wrench

- W/8" EXTENDED ANVIL
- MAX TORQUE: 3119Nm (2300ft-lb)

| Model No.  | Square Drive | Free Speed RPM | Max Torque |       | Overall Length |     | Air Inlet (PT) | Air Hose (ID) | Avg-Air Cons. |       | Net Weight |      | Packing Pcs/Ctn/G.W./Cuft (kgs) |
|------------|--------------|----------------|------------|-------|----------------|-----|----------------|---------------|---------------|-------|------------|------|---------------------------------|
|            |              |                | ft-lb      | n-m   | in.            | mm  |                |               | CFM           | l/min | lbs        | kgs. |                                 |
| AT-1838P   | 1"           | 5,000          | 1,800      | 2,441 | 19 1/2"        | 487 | 1/2"           | 3/4"          | 9.0           | 255   | 16.3       | 7.4  | 4/Ctn/31.0/1.20'                |
| AT-1838P-6 | 1"           | 5,000          | 1,700      | 2,350 | 23 1/2"        | 588 | 1/2"           | 3/4"          | 9.0           | 255   | 18.0       | 8.2  | 4/Ctn/33.0/1.80'                |
| AT-3804T   | 1"           | 4,600          | 1,800      | 2,441 | 21 2/5"        | 544 | 1/2"           | 1/2"          | 24.7          | 699   | 19.4       | 8.8  | 2/Ctn/20.6/0.84'                |
| AT-3886T   | 1"           | 5,000          | 1,800      | 2,441 | 20 3/5"        | 523 | 1/2"           | 1/2"          | 24.7          | 699   | 24.6       | 11.2 | 2/Ctn/25.8/1.84'                |
| AT-6088P   | 1"           | 3,400          | 1,800      | 2,441 | 11 1/2"        | 292 | 1/2"           | 1/2"          | 7.0           | 198   | 21.3       | 9.7  | 2/Ctn/23.0/1.64'                |
| AT-6088P-6 | 1"           | 3,400          | 1,800      | 2,441 | 14 1/2"        | 368 | 1/2"           | 1/2"          | 7.0           | 198   | 23.1       | 10.5 | 2/Ctn/24.6/1.80'                |
| AT-2106    | 3/4"         | 7,500          | 1,400      | 1,898 | 11 1/4"        | 286 | 1/2"           | 1/2"          | 10.6          | 300   | 9.9        | 4.5  | 4/Ctn/19.5/0.85'                |
| AT-2108    | 1"           | 7,500          | 1,400      | 1,898 | 11 1/4"        | 286 | 1/2"           | 1/2"          | 10.6          | 300   | 11.0       | 5.0  | 4/Ctn/20.5/0.85'                |
| AT-2106L   | 3/4"         | 7,500          | 1,300      | 1,763 | 17 1/10"       | 434 | 1/2"           | 1/2"          | 10.6          | 300   | 10.1       | 4.6  | 4/Ctn/22.4/1.20'                |
| AT-2108L   | 1"           | 7,500          | 1,300      | 1,763 | 17 1/10"       | 434 | 1/2"           | 1/2"          | 10.6          | 300   | 11.9       | 5.4  | 4/Ctn/23.2/1.20'                |
| AT-6562C   | 1"           | 4,500          | 2,000      | 2,712 | 18 1/2"        | 470 | 1/2"           | 1/2"          | 11.7          | 331   | 18.7       | 8.5  | 1/Ctn/9.0/0.70'                 |
| AT-6562B   | 1"           | 4,500          | 2,000      | 2,712 | 22 1/2"        | 570 | 1/2"           | 1/2"          | 11.7          | 331   | 20.5       | 9.3  | 1/Ctn/10.0/0.90'                |
| AT-6562A   | 1"           | 4,500          | 2,000      | 2,712 | 24 1/2"        | 620 | 1/2"           | 1/2"          | 11.7          | 331   | 21.5       | 9.8  | 1/Ctn/10.5/0.90'                |

| Model No.  | Square Drive | Free Speed RPM | Max Torque |       | Overall Length |     | Air Inlet (PT) | Air Hose (ID) | Avg-Air Cons. |       | Net Weight |      | Packing Pcs/Ctn/G.W./Cuft (kgs) |
|------------|--------------|----------------|------------|-------|----------------|-----|----------------|---------------|---------------|-------|------------|------|---------------------------------|
|            |              |                | ft-lb      | n-m   | in.            | mm  |                |               | CFM           | l/min | lbs        | kgs. |                                 |
| AT-6082    | 1"           | 3,500          | 1,800      | 2,441 | 14 7/8"        | 378 | 1/2"           | 1/2"          | 11.0          | 312.0 | 22.0       | 10.0 | 2/Ctn/23.8/1.47'                |
| AT-6082-8  | 1"           | 3,500          | 1,700      | 2,305 | 20 7/8"        | 530 | 1/2"           | 1/2"          | 11.0          | 312.0 | 24.2       | 11.0 | 2/Ctn/25.0/1.51'                |
| AT-6088    | 1"           | 3,300          | 1,800      | 2,441 | 15 3/8"        | 390 | 1/2"           | 1/2"          | 11.0          | 312.0 | 20.5       | 9.3  | 2/Ctn/21.0/1.10'                |
| AT-6088-6  | 1"           | 3,300          | 1,700      | 2,305 | 19 3/8"        | 492 | 1/2"           | 1/2"          | 11.0          | 312.0 | 22.7       | 10.3 | 2/Ctn/23.0/1.57'                |
| AT-6089B-6 | 1"           | 3,600          | 2,200      | 2,983 | 21 1/4"        | 550 | 1/2"           | 1/2"          | 11.0          | 312.0 | 25.74      | 11.7 | 2/Ctn/23.0/1.50'                |
| AT-6086-8  | 1"           | 4,000          | 2,500      | 3,390 | 24 2/5"        | 620 | 1/2"           | 1/2"          | 12.0          | 340.0 | 36.7       | 16.7 | 2/Ctn/23.0/1.50'                |
| AT-6762B   | 1"           | 2,600          | 2,500      | 3,390 | 15 3/4"        | 390 | 1/2"           | 1/2"          | 15.0          | 425.0 | 28.0       | 12.7 | 1/Ctn/15.0/0.60'                |
| AT-6762B-6 | 1"           | 2,600          | 2,400      | 3,254 | 19 3/4"        | 500 | 1/2"           | 1/2"          | 15.0          | 425.0 | 29.7       | 13.5 | 1/Ctn/16.0/0.70'                |
| AT-6762B-8 | 1"           | 2,600          | 2,400      | 3,254 | 23 1/4"        | 590 | 1/2"           | 1/2"          | 15.0          | 425.0 | 34.5       | 15.7 | 1/Ctn/16.0/0.70'                |
| AT-6090    | 1"           | 4,000          | 2,100      | 2,848 | 15 3/8"        | 390 | 1/2"           | 1/2"          | 10.0          | 283.0 | 19.8       | 9.0  | 2/Ctn/22.0/1.50'                |
| AT-6090-6  | 1"           | 3,300          | 2,000      | 2,712 | 17 5/8"        | 447 | 1/2"           | 1/2"          | 11.0          | 312.0 | 20.2       | 9.2  | 2/Ctn/20.9/1.57'                |
| AT-6090-8  | 1"           | 3,300          | 2,000      | 2,712 | 22"            | 560 | 1/2"           | 1/2"          | 11.0          | 312.0 | 20.9       | 9.5  | 2/Ctn/20.9/1.57'                |
| AT-6088B   | 1 1/2"       | 3,700          | 2,400      | 3,254 | 19 2/7"        | 490 | 1/2"           | 1/2"          | 11.0          | 312.0 | 32.8       | 14.9 | 1/Ctn/17.8/1.32'                |
| AT-6088B-8 | 1 1/2"       | 3,700          | 2,300      | 3,119 | 26"            | 660 | 1/2"           | 1/2"          | 11.0          | 312.0 | 35.4       | 16.1 | 1/Ctn/18.8/1.32'                |



**THRU-HOLE TYPE**

**AT-1012**  
1/4"DR. Mini Ratchet Wrench

- ACCESSORIES: 3/8", 1/2", 9/16" (10, 12, 13MM)

**AT-1016**  
3/8"DR. Ratchet Wrench

- MAX TORQUE: 41Nm (30ft-lb)  
- ACCESSORIES: 3/8", 1/2", 9/16" (10, 12, 13MM) & BITS HOLDER & ADAPTOR 3/8"  
- 1/4" ADAPTOR OPTIONAL



**IMPACT MECHANISM**

**AT-3018**  
3/8"DR. Impact Ratchet Wrench

**AT-2018**  
1/2"DR. Impact Ratchet Wrench

- MAX TORQUE: 81 Nm ( 60 ft-lb)



**AT-5055**  
1/4"DR. Ratchet Wrench

**AT-5055A**  
3/8"DR. Ratchet Wrench

- MAX TORQUE: 41Nm (30ft-lb)



**AT-2017**  
1/4"DR. Ratchet Wrench

**AT-3017**  
3/8"DR. Ratchet Wrench

- MAX TORQUE: 41Nm (30ft-lb)



**AT-2024**  
1/4"DR. Ratchet Wrench

**AT-3024**  
3/8"DR. Ratchet Wrench

- MAX TORQUE: 41Nm (30ft-lb)  
- Stubby Type



**AT-3022**  
3/8"DR. Ratchet Wrench

**AT-4022**  
1/2"DR. Ratchet Wrench

- MAX TORQUE: 81 Nm ( 60 ft-lb)



**EXHAUST 360° ROTATION**

**AT-2312**  
3/8"DR. Super Duty Ratchet Wrench

- MAX TORQUE: 108Nm (80ft-lb)

**AT-2412**  
1/2"DR. Super Duty Ratchet Wrench

- MAX TORQUE: 108Nm (80ft-lb)  
- COMPOSITE BODY



**EXHAUST 360° ROTATION**

**AT-2402**  
1/2"DR. Super Duty Ratchet Wrench

- COMPOSITE BODY  
- MAX TORQUE: 136Nm (100ft-lb)  
- A: WOBBLE  
B: W/DOUBLE FUNCTIONAL ANVIL



**AT-2401**  
1/4"DR. Ratchet Wrench

- MAX TORQUE: 27Nm (20ft-lb)

**AT-2403**  
3/8"DR. Ratchet Wrench

- MAX TORQUE: 54Nm (40ft-lb)



**AT-2407**  
1/2" DR. Super Duty Mini Ratchet Wrench

- COMPOSITE BODY  
- MAX. Torque: 54Nm (40ft-lb)  
- A: WOBBLE  
B: W/DOUBLE FUNCTIONAL ANVIL



1/2"DR. is also available w/ wobble drive anvil



**AT-5054**  
1/2"DR. Heavy Duty Ratchet Wrench

- TORQUE: 121Nm (90ft-lb)



| Model No. | Square Drive | Free Speed RPM | Max Torque |     | Overall Length |     | Air Inlet (PT) | Air Hose (ID) | Avg-Air Cons. |       | Net Weight |      | Packing Pcs/Ctn/G.W./Cuft (kgs) |
|-----------|--------------|----------------|------------|-----|----------------|-----|----------------|---------------|---------------|-------|------------|------|---------------------------------|
|           |              |                | ft-lb      | n-m | in.            | mm  |                |               | CFM           | l/min | lbs        | kgs. |                                 |
| AT-1012   | 1/4"         | 400            | 30         | 41  | 6.5"           | 167 | 1/4"           | 3/8"          | 4.5           | 127   | 1.87       | 0.85 | 20/Ctn/15.0/1.1'                |
| AT-1016   | 3/8"         | 450            | 30         | 41  | 8.3"           | 210 | 1/4"           | 3/8"          | 4.5           | 127   | 1.87       | 0.85 | 20/Ctn/17.0/1.1'                |
| AT-2017   | 1/4"         | 350            | 30         | 41  | 7"             | 180 | 1/4"           | 3/8"          | 4.5           | 127   | 1.54       | 0.7  | 20/Ctn/15.0/1.1'                |
| AT-3017   | 3/8"         | 350            | 30         | 41  | 7"             | 180 | 1/4"           | 3/8"          | 4.5           | 127   | 1.54       | 0.7  | 20/Ctn/15.0/1.1'                |
| AT-3022   | 3/8"         | 160            | 60         | 81  | 10.4"          | 265 | 1/4"           | 3/8"          | 5.0           | 142   | 2.64       | 1.2  | 20/Ctn/28.0/1.7'                |
| AT-4022   | 1/2"         | 160            | 60         | 81  | 10.4"          | 265 | 1/4"           | 3/8"          | 5.0           | 142   | 2.64       | 1.2  | 20/Ctn/28.0/1.7'                |
| AT-3018   | 3/8"         | 500            | 60         | 81  | 10.4"          | 265 | 1/4"           | 3/8"          | 5.0           | 142   | 2.86       | 1.3  | 20/Ctn/30.0/1.7'                |
| AT-2018   | 1/2"         | 500            | 60         | 81  | 10.4"          | 265 | 1/4"           | 3/8"          | 5.0           | 142   | 2.86       | 1.3  | 20/Ctn/30.0/1.7'                |
| AT-5055   | 1/4"         | 230            | 30         | 41  | 6 1/2"         | 165 | 1/4"           | 3/8"          | 4.0           | 113   | 1.1        | 0.5  | 20/Ctn/12.0/0.6'                |
| AT-5055A  | 3/8"         | 230            | 30         | 41  | 6 1/2"         | 165 | 1/4"           | 3/8"          | 4.0           | 113   | 1.1        | 0.5  | 20/Ctn/12.0/0.6'                |
| AT-3024   | 3/8"         | 300            | 30         | 41  | 5.6"           | 144 | 1/4"           | 3/8"          | 4.5           | 127   | 1.1        | 0.5  | 20/Ctn/12.0/1.0'                |
| AT-2024   | 1/4"         | 300            | 30         | 41  | 5.6"           | 144 | 1/4"           | 3/8"          | 4.5           | 127   | 1.1        | 0.5  | 20/Ctn/12.0/1.0'                |

| Model No. | Square Drive | Free Speed RPM | Max Torque |     | Overall Length |     | Air Inlet (PT) | Air Hose (ID) | Avg-Air Cons. |       | Net Weight |      | Packing Pcs/Ctn/G.W./Cuft (kgs) |
|-----------|--------------|----------------|------------|-----|----------------|-----|----------------|---------------|---------------|-------|------------|------|---------------------------------|
|           |              |                | ft-lb      | n-m | in.            | mm  |                |               | CFM           | l/min | lbs        | kgs. |                                 |
| AT-3138   | 3/8"         | 160            | 50         | 67  | 10.4"          | 265 | 1/4"           | 3/8"          | 4.0           | 113   | 2.9        | 1.32 | 10/Ctn/15.0/1.0'                |
| AT-4138   | 1/2"         | 160            | 50         | 68  | 10.4"          | 265 | 1/4"           | 3/8"          | 4.0           | 113   | 2.9        | 1.32 | 10/Ctn/15.0/1.0'                |
| AT-2401   | 1/4"         | 250            | 20         | 27  | 8.07"          | 205 | 1/4"           | 3/8"          | 2.8           | 79    | 1.5        | 0.7  | 30/Ctn/22.9/0.8'                |
| AT-2302   | 3/8"         | 270            | 40         | 54  | 8.07"          | 205 | 1/4"           | 3/8"          | 2.8           | 79    | 1.45       | 0.66 | 30/Ctn/22.9/0.8'                |
| AT-2312   | 3/8"         | 280            | 80         | 108 | 10.9"          | 277 | 1/4"           | 3/8"          | 4.0           | 113   | 2.7        | 1.24 | 12/Ctn/17.2/0.61'               |
| AT-2412   | 1/2"         | 280            | 80         | 108 | 10.9"          | 277 | 1/4"           | 3/8"          | 4.0           | 113   | 2.7        | 1.24 | 12/Ctn/17.2/0.61'               |
| AT-2407   | 1/2"         | 270            | 40         | 54  | 7.67"          | 195 | 1/4"           | 3/8"          | 2.8           | 79    | 1.45       | 0.7  | 30/Ctn/23.5/0.8'                |
| AT-2402   | 1/2"         | 225            | 100        | 136 | 12.4"          | 315 | 1/4"           | 3/8"          | 4.0           | 113   | 3.56       | 1.62 | 12/Ctn/17.2/0.61'               |
| AT-5054   | 1/2"         | 150            | 90         | 121 | 14.37"         | 365 | 1/4"           | 3/8"          | 6.0           | 170   | 4.4        | 2    | 10/Ctn/22.0/0.8'                |





**IS-8003**  
**IS-8004**

10pcs 1" Air Socket Set Cr-Mo Steel / Metal Box

| Item No. | Size   |
|----------|--|
| IS-8003  | 24 . 27 . 30 . 32 . 35 . 38 . 41 . 46 . 50 mm                          |
| IS-8004  | 1" . 1-1/8" . 1-1/4" . 1-3/8" . 1-1/2" . 1-5/8" . 1-3/4" . 1-7/8" . 2" |

- 4 SETS/CTN/26KG/1.1'



**IS-6003**  
**IS-6004**

9pcs 3/4" Air Socket Set Cr-Mo Steel / Metal Box

| Item No. | Size   |
|----------|--|
| IS-6003  | 26 . 27 . 29 . 30 . 32 . 35 . 36 . 38 mm                             |
| IS-6004  | 1" . 1-1/16" . 1-1/8" . 1-1/4" . 1-5/16" . 1-3/8" . 1-7/16" . 1-1/2" |

- 6 SETS/CTN/26KG/0.64'



**IS-4003**  
**IS-4004**

11pcs 1/2" Air Socket Set Cr-V Steel / Metal Box

| Item No. | Size  |
|----------|---|
| IS-4003  | 10 . 11 . 12 . 13 . 14 . 17 . 19 . 21 . 22 . 24 mm                        |
| IS-4004  | 7/16" . 1/2" . 9/16" . 5/8" . 11/16" . 3/4" . 13/16" . 7/8" . 15/16" . 1" |

- 20 SETS/CTN/29KG/0.65'



**IS-4007**  
**IS-4008**

8pcs 1/2" Air Universal Joint Cr-V Steel / Metal Box

| Item No. | Size  |
|----------|---|
| IS-4007  | 13 . 14 . 15 . 17 . 18 . 19 . 21 mm                 |
| IS-4008  | 1/2" . 9/16" . 5/8" . 11/16" . 3/4" . 13/16" . 7/8" |

- 15 SETS/CTN/26KG/0.65'



**IS-8005**  
**IS-8006**

8pcs 1" Deep Air Socket Set Cr-Mo Steel / Metal Box

| Item No. | Size   |
|----------|--|
| IS-8005  | 26 . 27 . 29 . 30 . 32 . 35 . 36 . 38 mm                             |
| IS-8006  | 1" . 1-1/16" . 1-1/8" . 1-1/4" . 1-5/16" . 1-3/8" . 1-7/16" . 1-1/2" |

- 4 SETS/CTN/30KG/0.67'



**IS-4001**  
**IS-4002**

12pcs 1/2" Deep Air Socket Set Cr-V Steel / Metal Box

| Item No. | Size   |
|----------|--|
| IS-4001  | 10 . 11 . 12 . 13 . 14 . 16 . 17 . 19 . 21 . 22 . 24 mm                          |
| IS-4002  | 3/8" . 7/16" . 1/2" . 9/16" . 5/8" . 11/16" . 3/4" . 13/16" . 7/8" . 15/16" . 1" |

- 10 SETS/CTN/26KG/0.52'



**IS-4005**  
**IS-4006**

10pcs 1/2" Air Socket Set Cr-Mo Steel / Metal Box

| Item No. | Size   |
|----------|--|
| IS-4005  | 11 . 12 . 13 . 14 . 16 . 17 . 19 . 21 . 22 mm                      |
| IS-4006  | 3/8" . 7/16" . 1/2" . 9/16" . 5/8" . 11/16" . 3/4" . 13/16" . 7/8" |

- 20 SETS/CTN/29KG/0.65'



**IS-3001**  
**IS-3002**

9pcs 3/8" Deep Air Socket Set Cr-V Steel / Metal Box

| Item No. | Size   |
|----------|--|
| IS-3001  | 8 . 10 . 12 . 13 . 14 . 15 . 17 . 19 mm                    |
| IS-3002  | 5/16" . 3/8" . 7/16" . 1/2" . 9/16" . 5/8" . 11/16" . 3/4" |

- 20 SETS/CTN/28KG/0.49'



**410-DSM**

1/2"DR 10Pcs Impact Socket Set

W/BLOW CASE CR-MO  
11,12,13,14,16,17,19,21,22MM



**411-DSM**

1/2"DR 11Pcs Impact Sockets Set

W/BLOW CASE CR-MO  
11 . 12 . 14 . 16 . 17 . 18 . 19 . 21 . 22 . 23MM



**421-DSM**

1/2"DR 16Pcs Impact Socket Set

W/BLOWCASE CR-MO  
10,11,12,13,14,15,16,17,18,19,20,21,22,24,27,30MM  
2PCS OF PIN, 2PCS OF O-RING



**408-D5EK**

1/2"DR 8Pcs Torque Ext. Bar Impact Socket Set

CR MO  
4PCS SOCKET (17,19,21,22MM)  
4PCS EXTENSION BAR (80/90/100/110FT-LB)  
RED BLOW CASE



**403-D5M**

1/2"DR 150L Impact Sockets Set

COLORFUL 17,19,21MM-CR MO  
RED BLOW CASE



**403-D5**

1/2"DR 85L Impact Sockets Set

COLORFUL 17,19,21MM-CR MO  
RED BLOW CASE



**405-D5**

1/2"DR 5Pcs 85L Deep Impact Socket Set

COLORFUL 17,19,21,22,27MM-CR MO  
RED BLOW CASE



**411-D5**

1/2"DR 11Pcs Deep Impact Socket Set

CR MO  
17,19,21,22,23,3/4",13/16",7/8",15/16",1",1-1/16"MM  
RED BLOW CASE





### 3/8"DR REGULAR LENGTH IMPACT SOCKET (DIN 3129 CR-MO STEEL)

| Item No. | Size (mm) | D1 (mm) | D2 (mm) | L (mm) | Item No. | Size (mm) | D1 (mm) | D2 (mm) | L (mm) | Item No. | Size (mm) | D1 (mm) | D2 (mm) | L (mm) |
|----------|-----------|---------|---------|--------|----------|-----------|---------|---------|--------|----------|-----------|---------|---------|--------|
| D031-06M | 6         | 10.8    | 19      | 32     | D031-12M | 12        | 18.4    | 19      | 32     | D031-18M | 18        | 25.9    | 22      | 32     |
| D031-07M | 7         | 12.1    | 19      | 32     | D031-13M | 13        | 19.6    | 22      | 32     | D031-19M | 19        | 27.1    | 22      | 32     |
| D031-08M | 8         | 13.5    | 19      | 32     | D031-14M | 14        | 20.9    | 22      | 32     | D031-20M | 20        | 28.7    | 22      | 32     |
| D031-09M | 9         | 14.6    | 19      | 32     | D031-15M | 15        | 22      | 22      | 32     | D031-21M | 21        | 30.3    | 22      | 32     |
| D031-10M | 10        | 15.9    | 19      | 32     | D031-16M | 16        | 23.4    | 22      | 32     | D031-22M | 22        | 31.6    | 22      | 32     |
| D031-11M | 11        | 17.2    | 19      | 32     | D031-17M | 17        | 24.6    | 22      | 32     |          |           |         |         |        |

### 3/8"DR DEEP LENGTH IMPACT SOCKET (DIN 3129 CR-MO STEEL)

| Item No. | Size (mm) | D1 (mm) | D2 (mm) | L (mm) | Item No. | Size (mm) | D1 (mm) | D2 (mm) | L (mm) | Item No. | Size (mm) | D1 (mm) | D2 (mm) | L (mm) |
|----------|-----------|---------|---------|--------|----------|-----------|---------|---------|--------|----------|-----------|---------|---------|--------|
| D033-06M | 6         | 10.8    | 19      | 63     | D033-12M | 12        | 18.4    | 19      | 63     | D033-18M | 18        | 25.9    | 22      | 63     |
| D033-07M | 7         | 12.1    | 19      | 63     | D033-13M | 13        | 19.6    | 22      | 63     | D033-19M | 19        | 27.1    | 22      | 63     |
| D033-08M | 8         | 13.5    | 19      | 63     | D033-14M | 14        | 20.9    | 22      | 63     | D033-20M | 20        | 28.7    | 22      | 63     |
| D033-09M | 9         | 14.6    | 19      | 63     | D033-15M | 15        | 22      | 22      | 63     | D033-21M | 21        | 30.3    | 22      | 63     |
| D033-10M | 10        | 15.9    | 19      | 63     | D033-16M | 16        | 23.4    | 22      | 63     | D033-22M | 22        | 31.6    | 22      | 63     |
| D033-11M | 11        | 17.2    | 19      | 63     | D033-17M | 17        | 24.6    | 22      | 63     |          |           |         |         |        |

### 1/2"DR REGULAR LENGTH IMPACT SOCKET (DIN 3129 CR-MO STEEL)

| Item No. | Size (mm) | D1 (mm) | D2 (mm) | L (mm) | Item No. | Size (mm) | D1 (mm) | D2 (mm) | L (mm) | Item No. | Size (mm) | D1 (mm) | D2 (mm) | L (mm) |
|----------|-----------|---------|---------|--------|----------|-----------|---------|---------|--------|----------|-----------|---------|---------|--------|
| D041-08M | 8         | 14.6    | 25      | 38     | D041-17M | 17        | 25.8    | 30      | 38     | D041-26M | 26        | 37      | 30      | 43     |
| D041-09M | 9         | 15.8    | 25      | 38     | D041-18M | 18        | 27.1    | 30      | 38     | D041-27M | 27        | 38.3    | 30      | 43     |
| D041-10M | 10        | 17.1    | 25      | 38     | D041-19M | 19        | 28.3    | 30      | 38     | D041-28M | 28        | 39.5    | 30      | 48     |
| D041-11M | 11        | 18.4    | 25      | 38     | D041-20M | 20        | 29.5    | 30      | 38     | D041-29M | 29        | 40.8    | 30      | 48     |
| D041-12M | 12        | 19.6    | 25      | 38     | D041-21M | 21        | 30.8    | 30      | 38     | D041-30M | 30        | 42.1    | 30      | 48     |
| D041-13M | 13        | 20.8    | 25      | 38     | D041-22M | 22        | 32.3    | 30      | 38     | D041-31M | 31        | 43.3    | 30      | 48     |
| D041-14M | 14        | 22.1    | 25      | 38     | D041-23M | 23        | 33.3    | 30      | 43     | D041-32M | 32        | 44.6    | 30      | 48     |
| D041-15M | 15        | 23.3    | 30      | 38     | D041-24M | 24        | 34.6    | 30      | 43     |          |           |         |         |        |
| D041-16M | 16        | 24.6    | 30      | 38     | D041-25M | 25        | 35.8    | 30      | 43     |          |           |         |         |        |

### 1/2"DR DEEP LENGTH IMPACT SOCKET (DIN 3129 CR-MO STEEL)

| Item No. | Size (mm) | D1 (mm) | D2 (mm) | L (mm) | Item No. | Size (mm) | D1 (mm) | D2 (mm) | L (mm) | Item No. | Size (mm) | D1 (mm) | D2 (mm) | L (mm) |
|----------|-----------|---------|---------|--------|----------|-----------|---------|---------|--------|----------|-----------|---------|---------|--------|
| D043-08M | 8         | 14.6    | 25      | 78     | D043-17M | 17        | 25.8    | 30      | 78     | D043-26M | 26        | 37      | 30      | 78     |
| D043-09M | 9         | 15.8    | 25      | 78     | D043-18M | 18        | 27.1    | 30      | 78     | D043-27M | 27        | 38.3    | 30      | 78     |
| D043-10M | 10        | 17.1    | 25      | 78     | D043-19M | 19        | 28.3    | 30      | 78     | D043-28M | 28        | 39.5    | 30      | 78     |
| D043-11M | 11        | 18.4    | 25      | 78     | D043-20M | 20        | 29.5    | 30      | 78     | D043-29M | 29        | 40.8    | 30      | 78     |
| D043-12M | 12        | 19.6    | 25      | 78     | D043-21M | 21        | 30.8    | 30      | 78     | D043-30M | 30        | 42.1    | 30      | 78     |
| D043-13M | 13        | 20.8    | 25      | 78     | D043-22M | 22        | 32.3    | 30      | 78     | D043-31M | 31        | 43.3    | 30      | 78     |
| D043-14M | 14        | 22.1    | 25      | 78     | D043-23M | 23        | 33.3    | 30      | 78     | D043-32M | 32        | 44.6    | 30      | 78     |
| D043-15M | 15        | 23.3    | 30      | 78     | D043-24M | 24        | 34.6    | 30      | 78     |          |           |         |         |        |
| D043-16M | 16        | 24.6    | 30      | 78     | D043-25M | 25        | 35.8    | 30      | 78     |          |           |         |         |        |

\* IMPERIAL SIZE AVAILABLE

### 3/8" ADAPTER

| Item No. | Size (mm) | D1 (mm) | L (mm) |
|----------|-----------|---------|--------|
| D03A-08M | 1/2"      | 22      | 36     |

### 1/2" ADAPTER

| Item No. | Size (mm) | D1 (mm) | L (mm) |
|----------|-----------|---------|--------|
| D04A-06M | 3/8"      | 25      | 38     |
| D04A-12M | 3/4"      | 25      | 48     |

### 3/4" ADAPTER

| Item No. | Size (mm) | D1 (mm) | L (mm) |
|----------|-----------|---------|--------|
| D06A-08M | 1/2"      | 44      | 58     |
| D06A-16M | 1"        | 44      | 64     |

### 1" ADAPTER

| Item No. | Size (mm) | D1 (mm) | L (mm) |
|----------|-----------|---------|--------|
| D08A-12M | 3/4"      | 54      | 75     |
| D08A-24M | 1-1/2"    | 54      | 90     |

### 3/4"DR REGULAR LENGTH IMPACT SOCKET (DIN 3129 CR-MO STEEL)

| Item No. | Size (mm) | D2 (mm) | L (mm) | Item No. | Size (mm) | D2 (mm) | L (mm) | Item No. | Size (mm) | D1 (mm) | D2 (mm) | L (mm) |
|----------|-----------|---------|--------|----------|-----------|---------|--------|----------|-----------|---------|---------|--------|
| D061-17M | 17        | 44      | 50     | D061-27M | 27        | 44      | 53     | D061-41M | 41        | 60.1    | 44      | 57     |
| D061-19M | 19        | 44      | 50     | D061-30M | 30        | 44      | 53     | D061-42M | 42        | 61.4    | 44      | 57     |
| D061-21M | 21        | 44      | 50     | D061-32M | 32        | 44      | 56     | D061-46M | 46        | 66.4    | 44      | 62     |
| D061-22M | 22        | 44      | 50     | D061-33M | 33        | 44      | 56     | D061-47M | 47        | 67.6    | 44      | 67     |
| D061-23M | 23        | 44      | 50     | D061-36M | 36        | 44      | 56     | D061-50M | 50        | 71.4    | 54      | 72     |
| D061-24M | 24        | 44      | 50     | D061-38M | 38        | 44      | 57     |          |           |         |         |        |
| D061-26M | 26        | 44      | 50     | D061-40M | 40        | 44      | 57     |          |           |         |         |        |

### 3/4"DR DEEP LENGTH IMPACT SOCKET (DIN 3129 CR-MO STEEL)

| Item No. | Size (mm) | D2 (mm) | L (mm) | Item No. | Size (mm) | D2 (mm) | L (mm) | Item No. | Size (mm) | D1 (mm) | D2 (mm) | L (mm) |
|----------|-----------|---------|--------|----------|-----------|---------|--------|----------|-----------|---------|---------|--------|
| D063-17M | 17        | 44      | 90     | D063-27M | 27        | 44      | 90     | D063-41M | 41        | 60.1    | 44      | 90     |
| D063-19M | 19        | 44      | 90     | D063-30M | 30        | 44      | 90     | D063-42M | 42        | 61.4    | 44      | 90     |
| D063-21M | 21        | 44      | 90     | D063-32M | 32        | 44      | 90     | D063-46M | 46        | 66.4    | 44      | 90     |
| D063-22M | 22        | 44      | 90     | D063-33M | 33        | 44      | 90     | D063-47M | 47        | 67.6    | 44      | 90     |
| D063-23M | 23        | 44      | 90     | D063-36M | 36        | 44      | 90     | D063-50M | 50        | 71.4    | 54      | 90     |
| D063-24M | 24        | 44      | 90     | D063-38M | 38        | 44      | 90     |          |           |         |         |        |
| D063-26M | 26        | 44      | 90     | D063-40M | 40        | 44      | 90     |          |           |         |         |        |

### 1"DR REGULAR LENGTH IMPACT SOCKET (DIN 3129 CR-MO STEEL)

| Item No. | Size (mm) | D1 (mm) | D2 (mm) | L (mm) | Item No. | Size (mm) | D1 (mm) | D2 (mm) | L (mm) | Item No. | Size (mm) | D1 (mm) | D2 (mm) | L (mm) |
|----------|-----------|---------|---------|--------|----------|-----------|---------|---------|--------|----------|-----------|---------|---------|--------|
| D081-19M | 19        | 35.6    | 54      | 58     | D081-30M | 30        | 49.4    | 54      | 60     | D081-38M | 38        | 59.4    | 54      | 65     |
| D081-21M | 21        | 38.1    | 54      | 58     | D081-31M | 31        | 50.6    | 54      | 60     | D081-41M | 41        | 63.1    | 54      | 65     |
| D081-23M | 23        | 40.6    | 54      | 58     | D081-32M | 32        | 51.9    | 54      | 61     | D081-46M | 46        | 69.4    | 54      | 74     |
| D081-24M | 24        | 41.9    | 54      | 58     | D081-33M | 33        | 53.6    | 54      | 61     | D081-50M | 50        | 74.4    | 54      | 74     |
| D081-27M | 27        | 45.6    | 54      | 58     | D081-35M | 35        | 55.7    | 54      | 61     | D081-55M | 55        | 80.7    | 54      | 85     |
| D081-28M | 28        | 47      | 54      | 58     | D081-36M | 36        | 56.9    | 54      | 65     | D081-60M | 60        | 87.1    | 54      | 89     |

### 1"DR DEEP LENGTH IMPACT SOCKET (DIN 3129 CR-MO STEEL)

| Item No. | Size (mm) | D1 (mm) | D2 (mm) | L (mm) | Item No. | Size (mm) | D1 (mm) | D2 (mm) | L (mm) | Item No. | Size (mm) | D1 (mm) | D2 (mm) | L (mm) |
|----------|-----------|---------|---------|--------|----------|-----------|---------|---------|--------|----------|-----------|---------|---------|--------|
| D083-19M | 19        | 35.6    | 54      | 90     | D083-30M | 30        | 49.4    | 54      | 90     | D083-38M | 38        | 59.4    | 54      | 90     |
| D083-21M | 21        | 38.1    | 54      | 90     | D083-31M | 31        | 50.6    | 54      | 90     | D083-41M | 41        | 63.1    | 54      | 90     |
| D083-23M | 23        | 40.6    | 54      | 90     | D083-32M | 32        | 51.9    | 54      | 90     | D083-46M | 46        | 69.4    | 54      | 100    |
| D083-24M | 24        | 41.9    | 54      | 90     | D083-33M | 33        | 53.6    | 54      | 90     | D083-50M | 50        | 74.4    | 54      | 100    |
| D083-27M | 27        | 45.6    | 54      | 90     | D083-35M | 35        | 55.7    | 54      | 90     | D083-55M | 55        | 80.7    | 54      | 100    |
| D083-28M | 28        | 47      | 54      | 90     | D083-36M | 36        | 56.9    | 54      | 90     | D083-60M | 60        | 87.1    | 54      | 120    |

\* IMPERIAL SIZE AVAILABLE



1/4" & 3/8" DRILL

3/8" DRILL

**AT-2014C**  
1/4" Mini Reversible Drill

- COMPOSITE HOUSING
- FREE SPEED: 2,600RPM



**AT-3038P**  
3/8" Reversible Drill

- COMPOSITE HOUSING
- FREE SPEED: 1,800RPM



**AT-4030E**  
3/8" Drill

- RUBBER HANDLE
- FREE SPEED: 2,200RPM



**AT-3038**  
3/8" Reversible Drill

- FREE SPEED: 1,800RPM



**AT-3038K**  
3/8" Reversible Drill

- RUBBER HANDLE
- W/KEYLESS CHUCK
- FREE SPEED: 1,800RPM



**AT-4030**  
3/8" Drill

- FREE SPEED: 2,200RPM



**AT-4031**  
3/8" Reversible Drill

- FREE SPEED: 1,800RPM



**AT-3630**  
3/8" Reversible Drill

- RUBBER HANDLE
- FREE SPEED: 2,200RPM



### Accessories



**4030**  
3/8" Chuck & Key



**4040**  
1/2" Chuck & Key



**4030C**  
3/8" Keyless Chuck



**4040C**  
1/2" Keyless Chuck

**AT-4037**  
3/8" Drill

- FREE SPEED: 1,800RPM



**AT-4037A**  
3/8" Reversible Drill

- FREE SPEED: 1,800RPM



**AT-4035**  
3/8" Angle Drill

- FREE SPEED: 1,900RPM



**AT-4038**  
3/8" Straight Drill

- RUBBER HANDLE
- FREE SPEED: 2,500RPM



**AT-4039**  
3/8" Straight Drill

- FREE SPEED: 4,000RPM



**AT-4038H**  
3/8" Straight Drill

- RUBBER HANDLE
- FREE SPEED: 2,500RPM

**AT-4031C**  
3/8" Keyless Reversible Drill

- FREE SPEED: 1,800RPM



**AT-4036**  
3/8" Reversible Angle Drill

- FREE SPEED: 1,800RPM



**AT-3038S**  
3/8" Straight Drill

- RUBBER HANDLE
- FREE SPEED: 2,500RPM



**AT-4038HK**  
3/8" Straight Drill

- COMPOSITE HOUSING
- FREE SPEED: 2,500RPM



| Model No. | Drilling Cap | Free Speed RPM | Overall Length |     | Air Inlet (PT) | Air Hose (ID) | Avg-Air Cons. |       | Net Weight |      | Packing Pcs/Ctn/G.W./Cuft (kgs) |
|-----------|--------------|----------------|----------------|-----|----------------|---------------|---------------|-------|------------|------|---------------------------------|
|           |              |                | in.            | mm  |                |               | CFM           | l/min | lbs        | kgs. |                                 |
| AT-2014C  | 1/4"         | 2,600          | 6 1/8"         | 155 | 1/4"           | 3/8"          | 3.2           | 90.6  | 1.1        | 0.5  | 20/Ctn/15/1.0'                  |
| AT-3038P  | 3/8"         | 1,800          | 8 2/7"         | 210 | 1/4"           | 3/8"          | 3.5           | 99.0  | 2.2        | 1.0  | 10/Ctn/13/0.9'                  |
| AT-4030E  | 3/8"         | 2,200          | 7 2/7"         | 185 | 1/4"           | 3/8"          | 4.0           | 113.3 | 2.4        | 1.1  | 10/Ctn/13/1.2'                  |
| AT-3038   | 3/8"         | 1,800          | 7 2/7"         | 185 | 1/4"           | 3/8"          | 4.0           | 113.3 | 2.4        | 1.1  | 10/Ctn/13/1.2'                  |
| AT-3038K  | 3/8"         | 1,800          | 7 2/7"         | 185 | 1/4"           | 3/8"          | 4.0           | 113.3 | 2.4        | 1.1  | 10/Ctn/13/1.2'                  |
| AT-4030   | 3/8"         | 2,200          | 6 1/2"         | 165 | 1/4"           | 3/8"          | 6.0           | 170.0 | 2.0        | 0.9  | 10/Ctn/13/1.2'                  |
| AT-4031   | 3/8"         | 1,800          | 6 1/2"         | 165 | 1/4"           | 3/8"          | 6.0           | 170.0 | 2.0        | 0.9  | 10/Ctn/13/1.2'                  |
| AT-3630   | 3/8"         | 2,200          | 6 7/8"         | 175 | 1/4"           | 3/8"          | 5.8           | 164.0 | 2.6        | 1.2  | 20/Ctn/23/1.5'                  |

| Model No. | Drilling Cap | Free Speed RPM | Overall Length |     | Air Inlet (PT) | Air Hose (ID) | Avg-Air Cons. |       | Net Weight |      | Packing Pcs/Ctn/G.W./Cuft (kgs) |
|-----------|--------------|----------------|----------------|-----|----------------|---------------|---------------|-------|------------|------|---------------------------------|
|           |              |                | in.            | mm  |                |               | CFM           | l/min | lbs        | kgs. |                                 |
| AT-4037   | 3/8"         | 1,800          | 9"             | 228 | 1/4"           | 3/8"          | 5.0           | 142   | 2.9        | 1.3  | 10/Ctn/14/0.9'                  |
| AT-4037A  | 3/8"         | 1,800          | 9"             | 228 | 1/4"           | 3/8"          | 5.0           | 142   | 2.9        | 1.3  | 10/Ctn/14/0.9'                  |
| AT-4031C  | 3/8"         | 1,800          | 6 1/2"         | 165 | 1/4"           | 3/8"          | 6.0           | 170   | 2.0        | 0.9  | 10/Ctn/13/1.2'                  |
| AT-4035   | 3/8"         | 1,900          | 7 3/7"         | 190 | 1/4"           | 3/8"          | 4.0           | 113   | 2.2        | 1.0  | 10/Ctn/11/0.7'                  |
| AT-4036   | 3/8"         | 1,800          | 8 1/4"         | 210 | 1/4"           | 3/8"          | 4.0           | 113   | 2.4        | 1.1  | 10/Ctn/20/1.0'                  |
| AT-4038   | 3/8"         | 2,500          | 9"             | 228 | 1/4"           | 3/8"          | 4.0           | 113   | 2.4        | 1.1  | 10/Ctn/11/0.7'                  |
| AT-4039   | 3/8"         | 4,000          | 9"             | 228 | 1/4"           | 3/8"          | 4.0           | 113   | 2.4        | 1.1  | 10/Ctn/11/0.7'                  |
| AT-3038S  | 3/8"         | 2,500          | 8 4/9"         | 215 | 1/4"           | 3/8"          | 4.0           | 113   | 2.2        | 1.0  | 10/Ctn/13/1.2'                  |
| AT-4038H  | 3/8"         | 2,500          | 8 3/4"         | 223 | 1/4"           | 3/8"          | 6.0           | 170   | 2.2        | 1.0  | 20/Ctn/21/0.7'                  |
| AT-4038HK | 3/8"         | 2,500          | 9"             | 228 | 1/4"           | 3/8"          | 4.5           | 127   | 2.1        | 0.9  | 20/Ctn/20/0.7'                  |





**AT-4012P**  
1/2" Reversible Drill

- COMPOSITE HOUSING  
- FREE SPEED: 800RPM



**AT-4500**  
1/2" Reversible Drill

- RUBBER HANDLE  
- FREE SPEED: 500RPM



**AT-4040**  
1/2" Drill

- FREE SPEED: 800RPM



**AT-4040E**  
1/2" Drill

- RUBBER HANDLE  
- FREE SPEED: 800RPM



**AT-4041**  
1/2" Reversible Drill



**AT-4012**  
1/2" Reversible Drill

**AT-4012RK**  
1/2" Reversible Key Less Drill



**AT-4531**  
1/2" Reversible Drill

- RUBBER HANDLE  
- FREE SPEED: 700RPM



**AT-26D**  
5/8" HD. Reversible Drill

- FREE SPEED: 1,000RPM

| Model No. | Drilling Cap | Free Speed RPM | Overall Length |     | Air Inlet (PT) | Air Hose (ID) | Avg. Air Cons. |       | Net Weight |      | Packing Pcs/Ctn/G.W./Cuft (kgs) |
|-----------|--------------|----------------|----------------|-----|----------------|---------------|----------------|-------|------------|------|---------------------------------|
|           |              |                | in.            | mm  |                |               | CFM            | l/min | lbs        | kgs. |                                 |
| AT-4012P  | 1/2"         | 800            | 9 2/3"         | 245 | 1/4"           | 3/8"          | 4.0            | 113.0 | 3.0        | 1.4  | 10/Ctn/16/1.0'                  |
| AT-4500   | 1/2"         | 500            | 9"             | 230 | 1/4"           | 3/8"          | 4.0            | 113.0 | 2.9        | 1.3  | 10/Ctn/15/1.0'                  |
| AT-4040E  | 1/2"         | 800            | 8 1/4"         | 210 | 1/4"           | 3/8"          | 4.0            | 113.0 | 2.4        | 1.1  | 10/Ctn/13/1.2'                  |
| AT-4012   | 1/2"         | 800            | 8 1/4"         | 210 | 1/4"           | 3/8"          | 4.0            | 113.0 | 2.4        | 1.1  | 10/Ctn/13/1.2'                  |
| AT-4012RK | 1/2"         | 800            | 8 1/4"         | 210 | 1/4"           | 3/8"          | 4.0            | 113.0 | 2.4        | 1.1  | 10/Ctn/13/1.2'                  |
| AT-4040   | 1/2"         | 800            | 7"             | 180 | 1/4"           | 3/8"          | 6.0            | 170.0 | 2.0        | 0.9  | 10/Ctn/19/1.0'                  |
| AT-4041   | 1/2"         | 800            | 7"             | 180 | 1/4"           | 3/8"          | 6.0            | 170.0 | 2.0        | 0.9  | 10/Ctn/19/1.0'                  |
| AT-4531   | 1/2"         | 700            | 8 3/4"         | 223 | 1/4"           | 3/8"          | 6.0            | 186.7 | 3.5        | 1.6  | 10/Ctn/14/1.0'                  |
| AT-26D    | 5/8"         | 1,000          | 14 1/2"        | 370 | 3/8"           | 1/2"          | 15.0           | 424.8 | 14.0       | 6.4  | 10/Ctn/15/0.75'                 |

**AT-2049**  
2" Angle Grinder

- FREE SPEED: 15,000RPM / LEVER TYPE



**AT-7138L**  
2" Angle Grinder

- FREE SPEED: 15,000RPM / ROLL TYPE



**AT-7138G**  
2" Angle Grinder

- FREE SPEED: 18,000RPM / ROLL TYPE



**AT-7036(G)**  
4" Angle Grinder

- FREE SPEED: 11,000RPM / LEVER TYPE (ROLL TYPE)



**AT-7037(G)**  
5" Angle Grinder

- FREE SPEED: 11,000RPM / LEVER TYPE (ROLL TYPE)



**AT-7041**  
7" Industrial Angle Grinder

- FREE SPEED: 7,000RPM / LEVER TYPE

**AT-7113(G)**  
3" 120° Angle Grinder

- FREE SPEED: 13,500RPM / LEVER TYPE (ROLL TYPE)

**AT-7114(G)**  
4" 120° Angle Grinder

- FREE SPEED: 9,300RPM / LEVER TYPE (ROLL TYPE)

**AT-7115(G)**  
5" 120° Angle Grinder

- FREE SPEED: 9,300RPM / LEVER TYPE (ROLL TYPE)

**AT-7117(G)**  
7" 120° Angle Grinder

- FREE SPEED: 7,000RPM / LEVER TYPE (ROLL TYPE)



**AT-7044L**  
4" Industrial Angle Grinder

- FREE SPEED: 13,600RPM / LEVER TYPE



**AT-7044G**  
4" Industrial Angle Grinder

- FREE SPEED: 13,600RPM / ROLL TYPE

**AT-7045L**  
5" Industrial Angle Grinder

- FREE SPEED: 10,900RPM / LEVER TYPE

**AT-7045G**  
5" Industrial Angle Grinder

- FREE SPEED: 10,900RPM / ROLL TYPE

**AT-7047L**  
7" Industrial Angle Grinder

- FREE SPEED: 7,600RPM / LEVER TYPE

**AT-7047G**  
7" Industrial Angle Grinder

- FREE SPEED: 7,600RPM / ROLL TYPE

| Model No.  | Disc Size | Free Speed RPM | Overall Length |     | Air Inlet (PT) | Air Hose (ID) | Avg. Air Cons. |       | Net Weight |      | Packing Pcs/Ctn/G.W./Cuft (kgs) |
|------------|-----------|----------------|----------------|-----|----------------|---------------|----------------|-------|------------|------|---------------------------------|
|            |           |                | in.            | mm  |                |               | CFM            | l/min | lbs        | kgs. |                                 |
| AT-2049    | 4" Pad    | 15,000         | 6 7/8"         | 175 | 1/4"           | 3/8"          | 4.5            | 127.0 | 1.3        | 0.6  | 20/Ctn/14.0/0.9'                |
| AT-7138L   | 4" Pad    | 15,000         | 6 2/3"         | 168 | 1/4"           | 3/8"          | 5.0            | 142.0 | 1.8        | 0.8  | 20/Ctn/18.0/0.9'                |
| AT-7138G   | 4" Pad    | 18,000         | 6 1/4"         | 158 | 1/4"           | 3/8"          | 5.0            | 142.0 | 1.5        | 0.7  | 20/Ctn/15.0/0.8'                |
| AT-7113(G) | 3" Pad    | 13,500         | 9 5/7"         | 250 | 1/4"           | 3/8"          | 4.0            | 113.0 | 2.64       | 1.2  | 10/Ctn/19.0/1.8'                |
| AT-7114(G) | 4" Pad    | 9,300          | 9 15/16"       | 260 | 1/4"           | 3/8"          | 4.0            | 113.0 | 3.74       | 1.7  | 10/Ctn/20.0/1.8'                |
| AT-7115(G) | 5" Pad    | 9,300          | 9 15/16"       | 260 | 1/4"           | 3/8"          | 4.0            | 113.0 | 3.74       | 1.7  | 10/Ctn/20.5/1.8'                |
| AT-7117(G) | 7" Pad    | 7,000          | 12 1/5"        | 310 | 1/4"           | 1/2"          | 5.0            | 142.0 | 6.38       | 2.9  | 6/Ctn/20.0/1.5'                 |
| AT-7036(G) | 4" Pad    | 11,000         | 9"             | 230 | 1/4"           | 3/8"          | 6.0            | 170.0 | 4.0        | 1.8  | 10/Ctn/21.5/1.45'               |
| AT-7037(G) | 5" Pad    | 11,000         | 9"             | 230 | 1/4"           | 3/8"          | 6.0            | 170.0 | 4.0        | 1.8  | 10/Ctn/21.5/1.45'               |
| AT-7044L   | 4" Pad    | 13,600         | 9 5/7"         | 246 | 1/4"           | 3/8"          | 21.0           | 590.0 | 2.9        | 1.3  | 10/Ctn/25.0/2.37'               |
| AT-7044G   | 4" Pad    | 13,600         | 9 1/3"         | 236 | 1/4"           | 3/8"          | 21.0           | 700.0 | 2.6        | 1.2  | 10/Ctn/24.0/2.37'               |
| AT-7045L   | 5" Pad    | 10,900         | 9 5/7"         | 246 | 1/4"           | 3/8"          | 25.0           | 790.0 | 3.0        | 1.4  | 10/Ctn/26.0/2.37'               |
| AT-7045G   | 5" Pad    | 10,900         | 9 1/3"         | 236 | 1/4"           | 3/8"          | 25.0           | 590.0 | 2.9        | 1.3  | 10/Ctn/25.0/2.37'               |
| AT-7047L   | 7" Pad    | 7,600          | 9 15/16"       | 253 | 1/4"           | 1/2"          | 28.0           | 700.0 | 6.8        | 3.1  | 4/Ctn/19.0/2.15'                |
| AT-7047G   | 7" Pad    | 7,600          | 9 3/5"         | 243 | 1/4"           | 1/2"          | 28.0           | 790.0 | 6.6        | 3.0  | 6/Ctn/27.0/3.13'                |
| AT-7041    | 7" Pad    | 7,000          | 13 1/2"        | 343 | 1/4"           | 1/2"          | 9.0            | 255.0 | 6.8        | 3.1  | 6/Ctn/24.5/2.5'                 |





**AT-7033D(M)**  
1/4" (6mm) Die Grinder

- RUBBER HANDLE  
- FREE SPEED: 22,000RPM



**AT-7033E(M)**  
1/4" (6mm) Die Grinder

- RUBBER HANDLE  
- LOW SPEED TYPE / FREE SPEED: 4,500RPM



**AT-7034D(M)**  
1/4" (6mm) Angle Die Grinder

- RUBBER HANDLE  
- FREE SPEED: 18,000RPM



**AT-7032(M)**  
1/4" (6mm) Mini Die Grinder

- FREE SPEED: 25,000RPM

**AT-7033(M)**  
1/4" (6mm) Die Grinder

- FREE SPEED: 22,000RPM



**AT-7033DL(M)**  
1/4" (6mm) Extended Die Grinder

- RUBBER HANDLE  
- FREE SPEED: 22,000RPM



**AT-2366(M)**  
1/4" (6mm) Die Grinder

- RUBBER HANDLE  
- COMPOSITE HOUSING / FREE SPEED: 16,000RPM



**AT-2367(M)**  
1/4" (6mm) Mini Die Grinder

- RUBBER HANDLE  
- COMPOSITE HOUSING / FREE SPEED: 22,000RPM



**AT-7033L(M)**  
1/4" (6mm) Extended Die Grinder

- FREE SPEED: 25,000RPM



**AT-7034(M)**  
1/4" (6mm) Angle Die Grinder

- FREE SPEED: 20,000RPM



**AT-7132(M)**  
1/4" (6mm) Die Grinder

- FREE SPEED: 18,000RPM

**AT-7130(M)**  
1/4" (6mm) Mini Die Grinder

- FREE SPEED: 25,000RPM



**AT-7133(M)**  
1/4" (6mm) Extended Die Grinder

- FREE SPEED: 25,000RPM



**AT-71363(M)**  
1/4" (6mm) 115° Angle Die Grinder

- FREE SPEED: 15,000RPM



**AT-7034C(M)**  
1/4" (6mm) Angle Die Grinder

- FREE SPEED: 18,000RPM



**AT-7134(M)**  
1/4" (6mm) Extended Die Grinder

- 3" LONG-EXTENDED TYPE / FREE SPEED: 25,000RPM

**AT-7135(M)**  
1/4" (6mm) Extended Die Grinder

- 5" LONG-EXTENDED TYPE

**AT-7135L(M)**  
1/4" (6mm) Extended Die Grinder

- 7" LONG-EXTENDED TYPE

| Model No.    | Collet Size |    | Free Speed RPM | Overall Length |     | Air Inlet (PT) | Air Hose (ID) | Avg-Air Consumption |       | Net Weight |      | Packing Pcs/Ctn/G.W./Cuft (kgs) |
|--------------|-------------|----|----------------|----------------|-----|----------------|---------------|---------------------|-------|------------|------|---------------------------------|
|              | in.         | mm |                | in.            | mm  |                |               | CFM                 | l/min | lbs        | kgs. |                                 |
| AT-7033D(M)  | 1/4"        | 6  | 22,000         | 6 3/4"         | 170 | 1/4"           | 3/8"          | 4.0                 | 113.0 | 1.5        | 0.7  | 20/Ctn/15/0.8'                  |
| AT-7033E(M)  | 1/4"        | 6  | 4,500          | 8 1/4"         | 210 | 1/4"           | 3/8"          | 4.0                 | 113.0 | 2.2        | 1.0  | 10/Ctn/12/1'                    |
| AT-7033DL(M) | 1/4"        | 6  | 22,000         | 10 1/4"        | 260 | 1/4"           | 3/8"          | 4.0                 | 113.0 | 1.5        | 0.7  | 10/Ctn/15/0.8'                  |
| AT-7034D(M)  | 1/4"        | 6  | 18,000         | 6 3/4"         | 170 | 1/4"           | 3/8"          | 4.0                 | 113.0 | 1.8        | 0.8  | 20/Ctn/17/0.8'                  |
| AT-2366(M)   | 1/4"        | 6  | 16,000         | 6 1/8"         | 155 | 1/4"           | 3/8"          | 3.5                 | 99.0  | 1.5        | 0.7  | 10/Ctn/13/0.9'                  |
| AT-2367(M)   | 1/4"        | 6  | 22,000         | 5 1/8"         | 130 | 1/4"           | 3/8"          | 4.0                 | 113.0 | 1.1        | 0.5  | 20/Ctn/12/0.8'                  |
| AT-7033(M)   | 1/4"        | 6  | 22,000         | 6 1/3"         | 160 | 1/4"           | 3/8"          | 4.0                 | 113.0 | 1.8        | 0.8  | 20/Ctn/16.5/0.9'                |
| AT-7032(M)   | 1/4"        | 6  | 25,000         | 5 1/2"         | 140 | 1/4"           | 3/8"          | 4.0                 | 113.0 | 0.7        | 0.3  | 25/Ctn/14/0.75'                 |
| AT-7033L(M)  | 1/4"        | 6  | 25,000         | 10 1/4"        | 260 | 1/4"           | 3/8"          | 4.0                 | 113.0 | 1.8        | 0.6  | 20/Ctn/22.7/1'                  |

| Model No.   | Collet Size |    | Free Speed RPM | Overall Length |     | Air Inlet (PT) | Air Hose (ID) | Avg-Air Consumption |       | Net Weight |      | Packing Pcs/Ctn/G.W./Cuft (kgs) |
|-------------|-------------|----|----------------|----------------|-----|----------------|---------------|---------------------|-------|------------|------|---------------------------------|
|             | in.         | mm |                | in.            | mm  |                |               | CFM                 | l/min | lbs        | kgs. |                                 |
| AT-7034(M)  | 1/4"        | 6  | 20,000         | 5 3/4"         | 146 | 1/4"           | 3/8"          | 4.0                 | 113.0 | 1.3        | 0.6  | 25/Ctn/19/0.75'                 |
| AT-71363(M) | 1/4"        | 6  | 15,000         | 6 7/8"         | 175 | 1/4"           | 3/8"          | 4.0                 | 113.0 | 1.5        | 0.7  | 20/Ctn/12/0.8'                  |
| AT-7132(M)  | 1/4"        | 6  | 18,000         | 7 1/4"         | 184 | 1/4"           | 3/8"          | 4.0                 | 113.0 | 1.8        | 0.8  | 20/Ctn/16/1.2'                  |
| AT-7130(M)  | 1/4"        | 6  | 25,000         | 6 1/3"         | 160 | 1/4"           | 3/8"          | 4.0                 | 113.0 | 0.9        | 0.4  | 20/Ctn/8.5/0.55'                |
| AT-7034C(M) | 1/4"        | 6  | 18,000         | 6 1/2"         | 165 | 1/4"           | 3/8"          | 4.0                 | 113.0 | 1.3        | 0.6  | 20/Ctn/13.5/1'                  |
| AT-7133(M)  | 1/4"        | 6  | 25,000         | 7 7/8"         | 200 | 1/4"           | 3/8"          | 4.0                 | 113.0 | 1.3        | 0.6  | 20/Ctn/13.5/1'                  |
| AT-7134(M)  | 1/4"        | 6  | 25,000         | 9 1/4"         | 235 | 1/4"           | 3/8"          | 4.0                 | 113.0 | 1.5        | 0.7  | 20/Ctn/14.5/1'                  |
| AT-7135(M)  | 1/4"        | 6  | 25,000         | 11 1/4"        | 285 | 1/4"           | 3/8"          | 4.0                 | 113.0 | 1.8        | 0.8  | 20/Ctn/15.5/1.2'                |
| AT-7135L(M) | 1/4"        | 6  | 25,000         | 13 1/4"        | 335 | 1/4"           | 3/8"          | 4.0                 | 113.0 | 2.0        | 0.9  | 20/Ctn/16.5/1.2'                |



## LOW NOISE SERIES



**AT-R7033L(M)**  
1/4" (6mm) Die Grinder

- RUBBER HANDLE
- FREE SPEED: 22,000RPM



**AT-R7245L(M)**  
1/4" (6mm) Die Grinder

- RUBBER HANDLE
- LOW SPEED TYPE
- FREE SPEED: 2,600RPM



**AT-R7136L(M)**  
1/4" (6mm) Angle Die Grinder

- RUBBER HANDLE
- FREE SPEED: 18,000RPM

**AT-R7265L(M)**  
1/4" (6mm) Die Grinder

- RUBBER HANDLE
- LOW SPEED TYPE
- Free Speed: 3,600RPM



**AT-R2115L(M)**  
1/4" (6mm) 115° Angle Die Grinder

- RUBBER HANDLE
- FREE SPEED: 18,000RPM



**AT-R7135L(M)**  
1/4" (6mm) Extended Die Grinder

- RUBBER HANDLE
- FREE SPEED: 22,000RPM

## MICRO GRINDER



**AT-3160H**  
120° Angle Grinder

- FREE SPEED: 35,000RPM



**AT-3170**  
Micro Grinder

- FREE SPEED: 54,000RPM



**AT-3180**  
Micro Grinder

- FREE SPEED: 70,000RPM

| Model No.    | Collet Size |    | Free Speed RPM | Overall Length |     | Air Inlet (PT) | Air Hose (ID) | Avg-Air Consumption |       | Net Weight |      | Packing Pcs/Ctn/G.W./Cuft (kgs) |
|--------------|-------------|----|----------------|----------------|-----|----------------|---------------|---------------------|-------|------------|------|---------------------------------|
|              | in.         | mm |                | in.            | mm  |                |               | CFM                 | l/min | lbs        | kgs. |                                 |
| AT-R7033L(M) | 1/4"        | 6  | 22,000         | 7"             | 178 | 1/4"           | 3/8"          | 3.5                 | 99.0  | 1.3        | 0.6  | 12/Ctn/9.8/0.8'                 |
| AT-R7245L(M) | 1/4"        | 6  | 2,600          | 7 7/8"         | 200 | 1/4"           | 3/8"          | 3.5                 | 99.0  | 1.5        | 0.7  | 12/Ctn/12.1/1.1'                |
| AT-R7265L(M) | 1/4"        | 6  | 3,600          | 7 7/8"         | 200 | 1/4"           | 3/8"          | 3.5                 | 99.0  | 1.5        | 0.7  | 12/Ctn/12.1/1.1'                |
| AT-R7135L(M) | 1/4"        | 6  | 22,000         | 11"            | 280 | 1/4"           | 3/8"          | 3.5                 | 99.0  | 1.8        | 0.8  | 12/Ctn/13.0/1.1'                |
| AT-R7136L(M) | 1/4"        | 6  | 18,000         | 7"             | 178 | 1/4"           | 3/8"          | 3.5                 | 99.0  | 1.5        | 0.7  | 12/Ctn/11.8/0.8'                |
| AT-R2115L(M) | 1/4"        | 6  | 18,000         | 7"             | 178 | 1/4"           | 3/8"          | 3.5                 | 99.0  | 1.5        | 0.7  | 12/Ctn/11.8/0.8'                |
| AT-3160H     | 1/8"        | 3  | 35,000         | 6 3/4"         | 170 | 1/4"           | 1/4"          | 2.0                 | 57.0  | 0.7        | 0.3  | 20/Ctn/11.0/1.0'                |
| AT-3170      | 1/8"        | 3  | 54,000         | 5 1/5"         | 132 | 1/4"           | 1/4"          | 2.0                 | 57.0  | 0.4        | 0.2  | 20/Ctn/15.0/2.2'                |
| AT-3180      | 1/8"        | 3  | 70,000         | 5 1/5"         | 132 | 1/4"           | 1/4"          | 2.0                 | 57.0  | 0.4        | 0.2  | 20/Ctn/15.0/2.2'                |



**AT-7080(M)(G)**  
1/4" (6mm) Die Grinder

- RUBBER HANDLE / LEVER TYPE (ROLL TYPE)
- FREE SPEED: 20,000RPM



**AT-7082(M)(G)**  
1/4" (6mm) Die Grinder

- 1.0HP / LEVER TYPE (ROLL TYPE)
- FREE SPEED: 21,000RPM



**AT-7081(M)(G)**  
1/4" (6mm) Die Grinder

- 0.9HP / LEVER TYPE (ROLL TYPE)
- RUBBER HANDLE
- FREE SPEED: 18,000RPM



**AT-7082L(M)(G)**  
1/4" (6mm) Extended Die Grinder

- 1.0HP / LEVER TYPE (ROLL TYPE)
- FREE SPEED: 21,000RPM



**AT-7080L(M)(G)**  
1/4" (6mm) Extended Die Grinder

- RUBBER HANDLE / LEVER TYPE (ROLL TYPE)
- FREE SPEED: 18,000RPM



**AT-7082XL(M)(G)**  
1/4" (6mm) Extended Die Grinder

- 1.0HP / LEVER TYPE (ROLL TYPE)
- FREE SPEED: 21,000RPM

| Model No.       | Collet Size |    | Free Speed RPM | Overall Length |     | Air Inlet (PT) | Air Hose (ID) | Avg-Air Consumption |       | Net Weight |      | Packing Pcs/Ctn/G.W./Cuft (kgs) |
|-----------------|-------------|----|----------------|----------------|-----|----------------|---------------|---------------------|-------|------------|------|---------------------------------|
|                 | in.         | mm |                | in.            | mm  |                |               | CFM                 | l/min | lbs        | kgs. |                                 |
| AT-7080(M)(G)   | 1/4"        | 6  | 20,000         | 6 1/2"         | 165 | 1/4"           | 3/8"          | 4                   | 113   | 1.5        | 0.7  | 20/Ctn/18.0/1.1'                |
| AT-7081(M)(G)   | 1/4"        | 6  | 18,000         | 7 7/10"        | 195 | 1/4"           | 3/8"          | 5                   | 141   | 2.6        | 1.2  | 20/Ctn/25.0/0.8'                |
| AT-7080L(M)(G)  | 1/4"        | 6  | 18,000         | 12 3/5"        | 320 | 1/4"           | 3/8"          | 4                   | 113   | 2.4        | 1.1  | 20/Ctn/28.0/1.7'                |
| AT-7082(M)(G)   | 1/4"        | 6  | 21,000         | 6 1/2"         | 166 | 1/4"           | 3/8"          | 5                   | 141   | 2.6        | 1.2  | 20/Ctn/22.3/1.1'                |
| AT-7082L(M)(G)  | 1/4"        | 6  | 21,000         | 12 4/5"        | 315 | 1/4"           | 3/8"          | 5                   | 141   | 3.6        | 1.65 | 12/Ctn/28.7/1.0'                |
| AT-7082XL(M)(G) | 1/4"        | 6  | 21,000         | 23 3/5"        | 600 | 1/4"           | 3/8"          | 5                   | 141   | 6.2        | 2.8  | 4 /Ctn/22.0/0.7'                |



**AIR SPOT DRILL**
**SAW**

**AT-6051A**

Spot Drill

- FREE SPEED: 1,400RPM

**AT-6111**

Body Saw W/2pcs Blade (24T.32T)

 - RUBBER HANDLE  
 - STROKE PER MINUTE: 9,000BPM

**AT-6054H**

Spot Drill

 - W/ 2" HOOK  
 - FREE SPEED: 1,800RPM

**AT-6011**

Body Saw

 - RUBBER HANDLE  
 - STROKE PER MINUTE: 9,000BPM

**AT-317HD**

Spot Drill

 - RUBBER HANDLE  
 - W/ 2" HOOK  
 - FREE SPEED: 1,600RPM

**AT-6011B**

Mini Saw W/2pcs Files

 - RUBBER HANDLE  
 - STROKE PER MINUTE: 5,000BPM

| Model No. | Drilling Bit mm | Free Speed RPM | Overall Length |     | Air Inlet (PT) | Air Hose (ID) | Avg-Air Consumption |       | Net Weight |      | Packing Pcs/Ctn/G.W./Cuft (kgs) |
|-----------|-----------------|----------------|----------------|-----|----------------|---------------|---------------------|-------|------------|------|---------------------------------|
|           |                 |                | in.            | mm  |                |               | CFM                 | l/min | lbs        | kgs. |                                 |
| AT-6051A  | 8 or 6.5        | 1,400          | 12"            | 310 | 1/4"           | 3/8"          | 4.0                 | 113.0 | 3.96       | 1.8  | 5 /Ctn/10.0/0.5'                |
| AT-6054H  | 8 or 6.5        | 1,800          | 11"            | 280 | 1/4"           | 3/8"          | 6.0                 | 170.0 | 2.6        | 1.2  | 10/Ctn/24.0/1.4'                |
| AT-317HD  | 8 or 6.5        | 1,600          | 11 2/5"        | 290 | 1/4"           | 3/8"          | 6.0                 | 170.0 | 1.8        | 0.8  | 10/Ctn/18.0/1.4'                |

| Model No. | Cutting Steel mm | Capacity Alum. mm | Stroke Per Min BPM | Overall Length |     | Air Inlet (PT) | Air Hose (ID) | Avg-Air Consumption |       | Net Weight |      | Packing Pcs/Ctn/G.W./Cuft (kgs) |
|-----------|------------------|-------------------|--------------------|----------------|-----|----------------|---------------|---------------------|-------|------------|------|---------------------------------|
|           |                  |                   |                    | in.            | mm  |                |               | CFM                 | l/min | lbs        | kgs. |                                 |
| AT-6111   | 1.6              | 2.0               | 9,000              | 9 1/4"         | 235 | 1/4"           | 3/8"          | 4.0                 | 113.0 | 1.8        | 0.8  | 20/Ctn/15.0/1.0'                |
| AT-6011   | 1.6              | 2.0               | 10,000             | 9 1/4"         | 235 | 1/4"           | 3/8"          | 6.0                 | 170.0 | 1.8        | 0.8  | 20/Ctn/15.5/1.0'                |
| AT-6011B  | 1.6              | 2.0               | 5,000              | 9 7/8"         | 250 | 1/4"           | 3/8"          | 6.0                 | 170.0 | 2.2        | 1.0  | 10/Ctn/10.0/1.4'                |

**AT-6052**

Air Punch &amp; Flange

- PUNCH HOLD DIA.: 5MM on 1.6MM of STEEL

**AT-6053**

Air Punch &amp; Flange

- PUNCH HOLD DIA.: 5MM on 1.6MM of STEEL

**AT-6052A**

Air Punch &amp; Flange

- PUNCH HOLD DIA.: 8MM on 1.2MM of STEEL

**AT-6053A**

Air Punch &amp; Flange

- PUNCH HOLD DIA.: 8MM on 1.2MM of STEEL

**AT-6026**

Air Nibbler

- STROKE PER MINUTE: 3,500BPM

**AT-6026A**

Air Nibbler

 - STROKE PER MINUTE: 3,500BPM  
 - PULL TYPE

**AT-6020**

Air Straight Metal Shear

- FREE SPEED: 2,500RPM

**AT-6021**

Air Pistol Metal Shear

- FREE SPEED: 2,500RPM

**AT-6020A**

Air Straight Metal Shear

 - RUBBER HANDLE  
 - FREE SPEED: 2,500RPM

**AT-6022**

Air Pistol Metal Shear

 - RUBBER HANDLE  
 - FREE SPEED: 2,200RPM

| Model No. | Capacity mm | Punch Hold Dia. mm | Overall Length |     | Air Inlet (PT) | Air Hose (ID) | Avg-Air Consumption |       | Net Weight |      | Packing Pcs/Ctn/G.W./Cuft (kgs) |
|-----------|-------------|--------------------|----------------|-----|----------------|---------------|---------------------|-------|------------|------|---------------------------------|
|           |             |                    | in.            | mm  |                |               | CFM                 | l/min | lbs        | kgs. |                                 |
| AT-6052   | 1.6         | 5                  | 9 6/7"         | 250 | 1/4"           | 3/8"          | 3.0                 | 85.0  | 2.9        | 1.3  | 10/Ctn/13.5/0.8'                |
| AT-6052A  | 1.2         | 8                  | 9 6/7"         | 250 | 1/4"           | 3/8"          | 3.0                 | 85.0  | 3.1        | 1.4  | 10/Ctn/14.5/0.82'               |
| AT-6053   | 1.6         | 5                  | 7 1/2"         | 190 | 1/4"           | 3/8"          | 2.2                 | 62.0  | 24         | 11   | 10/Ctn/12.0/1.0'                |
| AT-6053A  | 1.2         | 8                  | 7 1/2"         | 190 | 1/4"           | 3/8"          | 2.2                 | 62.0  | 26         | 12   | 10/Ctn/13.0/1.0'                |

| Model No. | Cutting Steel mm | Capacity Alum. mm | Stroke Per Min BPM | Overall Length |     | Air Inlet (PT) | Air Hose (ID) | Avg-Air Consumption |       | Net Weight |      | Packing Pcs/Ctn/G.W./Cuft (kgs) |
|-----------|------------------|-------------------|--------------------|----------------|-----|----------------|---------------|---------------------|-------|------------|------|---------------------------------|
|           |                  |                   |                    | in.            | mm  |                |               | CFM                 | l/min | lbs        | kgs. |                                 |
| AT-6026   | 1.4              | 2.0               | 2,900              | 7 1/8"         | 180 | 1/4"           | 3/8"          | 6.0                 | 170.0 | 2.2        | 1.0  | 20/Ctn/20.5/1.0'                |
| AT-6026A  | 1.4              | 2.0               | 3,200              | 8 1/4"         | 210 | 1/4"           | 3/8"          | 6.0                 | 170.0 | 1.8        | 0.8  | 20/Ctn/17.5/1.2'                |

| Model No. | Width of Cut |     | Free Speed RPM | Overall Length |     | Air Inlet (PT) | Air Hose (ID) | Avg-Air Consumption |       | Net Weight |      | Packing Pcs/Ctn/G.W./Cuft (kgs) |
|-----------|--------------|-----|----------------|----------------|-----|----------------|---------------|---------------------|-------|------------|------|---------------------------------|
|           | in.          | mm  |                | in.            | mm  |                |               | CFM                 | l/min | lbs        | kgs. |                                 |
| AT-6020   | 7/32"        | 5.5 | 2,500          | 9"             | 230 | 1/4"           | 3/8"          | 6.0                 | 170.0 | 2.2        | 1.0  | 10/Ctn/12.0/0.9'                |
| AT-6021   | 7/32"        | 5.5 | 2,500          | 7 1/2"         | 190 | 1/4"           | 3/8"          | 6.0                 | 170.0 | 2.4        | 1.1  | 10/Ctn/13.0/0.9'                |
| AT-6020A  | 7/32"        | 5.5 | 2,500          | 9 6/7"         | 250 | 1/4"           | 3/8"          | 4.0                 | 113.0 | 2.6        | 1.2  | 10/Ctn/13.0/0.9'                |
| AT-6022   | 7/32"        | 5.5 | 2,200          | 8 1/2"         | 215 | 1/4"           | 3/8"          | 4.0                 | 113.0 | 2.9        | 1.3  | 10/Ctn/16.0/1.2'                |



**CUT OFF TOOL**
**AT-6054B**
**Air Punch**

- PUNCH HOLD DIA: 6\*20MM on 1.2MM of STEEL

**AIR KNIFE**
**AT-6014**
**Knife**

- FREE SPEED: 20,000RPM

**AT-6014D**
**Knife**

 - RUBBER HANDLE  
 - FREE SPEED: 20,000RPM

**PRUNING SHEAR**
**AT-6001**
**Pruning Shear**

- CUTTING CAPACITY: 20MM

**AT-6027**
**3" Cut Off Tool**

- FREE SPEED: 18,000RPM

**AT-6030MA**
**3" Cut Off Tool**

 - RUBBER HANDLE  
 - FREE SPEED: 20,000RPM

**AT-6028**
**3" Cut Off Tool**

 - RUBBER HANDLE  
 - FREE SPEED: 15,000RPM

**AT-6254A**
**4" Extended Cut Off Tool**

- FREE SPEED: 15,000RPM



| Model No. | Capacity mm         | Punch Hold Dia. mm | Overall Length |                | Air Inlet (PT) | Air Hose (ID)  | Avg-Air Consumption |                     | Net Weight |            | Packing Pcs/Ctn/G.W./Cuft (kgs) |                                 |
|-----------|---------------------|--------------------|----------------|----------------|----------------|----------------|---------------------|---------------------|------------|------------|---------------------------------|---------------------------------|
|           |                     |                    | in.            | mm             |                |                | CFM                 | l/min               | lbs        | kgs.       |                                 |                                 |
| AT-6054B  | 1.2                 | 6*20               | 11"            | 275            | 1/4"           | 3/8"           | 3.0                 | 85.0                | 3.74       | 1.7        | 10/Ctn/18.0/1.2'                |                                 |
| Model No. | Cutting Distance mm | Free Speed RPM     | Overall Length |                | Air Inlet (PT) | Air Hose (ID)  | Avg-Air Consumption |                     | Net Weight |            | Packing Pcs/Ctn/G.W./Cuft (kgs) |                                 |
|           |                     |                    | in.            | mm             |                |                | CFM                 | l/min               | lbs        | kgs.       |                                 |                                 |
| AT-6014   | 3                   | 20,000             | 10 1/2"        | 268            | 1/4"           | 3/8"           | 6.0                 | 170.0               | 2.4        | 1.1        | 10/Ctn/12.3/1.4'                |                                 |
| AT-6014D  | 3                   | 20,000             | 7 5/7"         | 195            | 1/4"           | 3/8"           | 4.0                 | 113.0               | 2.2        | 1.0        | 10/Ctn/12.0/0.9'                |                                 |
| Model No. | Cutting Wheel       |                    | Free Speed RPM | Overall Length |                | Air Inlet (PT) | Air Hose (ID)       | Avg-Air Consumption |            | Net Weight |                                 | Packing Pcs/Ctn/G.W./Cuft (kgs) |
|           | in.                 | mm                 |                | in.            | mm             |                |                     | CFM                 | l/min      | lbs        | kgs.                            |                                 |
| AT-6027   | 3"                  | 76.2               | 18,000         | 7 1/2"         | 190            | 1/4"           | 3/8"                | 6.0                 | 170.0      | 1.8        | 0.8                             | 10/Ctn/16.0/1.4'                |
| AT-6030MA | 3"                  | 76.2               | 20,000         | 7"             | 180            | 1/4"           | 3/8"                | 4.0                 | 113.0      | 1.8        | 0.8                             | 10/Ctn/10.0/1.0'                |
| AT-6028   | 4"                  | 102                | 15,000         | 13 4/5"        | 350            | 1/4"           | 3/8"                | 4.0                 | 113.0      | 3.04       | 1.38                            | 5/Ctn/10.0/0.5'                 |
| AT-6254A  | 3"                  | 76.2               | 15,000         | 8 1/4"         | 210            | 1/4"           | 3/8"                | 4.0                 | 113.0      | 2.0        | 0.9                             | 10/Ctn/11.0/1.0'                |
| Model No. | Cutting Capacity mm | Width of Cut mm    | Overall Length |                | Air Inlet (PT) | Air Hose (ID)  | Avg-Air Consumption |                     | Net Weight |            | Packing Pcs/Ctn/G.W./Cuft (kgs) |                                 |
|           |                     |                    | in.            | mm             |                |                | CFM                 | l/min               | lbs        | kgs.       |                                 |                                 |
| AT-6001   | 20                  | 4.76               | 9 7/8"         | 250            | 1/4"           | 3/8"           | 1.8                 | 51.0                | 1.8        | 0.8        | 20/Ctn/15.5/1.8'                |                                 |

**AT-3100**
**Speed Nailer**

- STROKE PER MINUTE: 1,000BPM

**AT-3110**
**Speed Hammer**

- STROKE PER MINUTE: 1,000BPM

**AT-6034E**
**Smart Eraser**

 - RUBBER HANDLE  
 - FREE SPEED: 2,500RPM

**TIRE BUFFER**

**AT-6055**
**Tire Buffer W/Metal Wheel**

- FREE SPEED: 2,500RPM

**AT-6056E**
**H.D. Tire Buffer**

 - RUBBER HANDLE  
 - FREE SPEED: 2,500RPM

**AT-6056A**
**H.D. Tire Buffer**

 - RUBBER HANDLE  
 - QUICK CHANGE CHUCK  
 - FREE SPEED: 2,500RPM

**CAULKING GUN**

**AT-6040**
**Caulking Gun**

 - CAPACITY: 9" (310ML)  
 - METAL BODY

**AT-2032M-13**
**2 IN 1 Caulking Gun**

 - CAPACITY: 500ml (CARTRIDGE TYPE)  
 310-600ml (SACHET TYPE)  
 - ALUMINUM BODY

**AT-2033MC-13**
**3 IN 1 Caulking Gun**

 - CAPACITY: 500ml (CARTRIDGE TYPE)  
 310-600ml (SACHET TYPE)  
 - ALUMINUM BODY

| Model No.    | Stroke Per Min. BMP | Work Air Pressure PSI | Overall Length |                | Air Inlet (PT) | Air Hose (ID)  | Avg-Air Consumption |                     | Net Weight |            | Packing Pcs/Ctn/G.W./Cuft (kgs) |                                 |
|--------------|---------------------|-----------------------|----------------|----------------|----------------|----------------|---------------------|---------------------|------------|------------|---------------------------------|---------------------------------|
|              |                     |                       | in.            | mm             |                |                | CFM                 | l/min               | lbs        | kgs.       |                                 |                                 |
| AT-3100      | 1000                | 50-125                | 5"             | 127            | 1/4"           | 3/8"           | 5.0                 | 142.0               | 2.6        | 1.2        | 10/Ctn/12.5/0.8'                |                                 |
| AT-3110      | 1000                | 50-125                | 3 7/8"         | 100            | 1/4"           | 3/8"           | 5.0                 | 142.0               | 2.2        | 1.0        | 10/Ctn/11.0/0.7'                |                                 |
| Model No.    | Sanding/Chuck Size  |                       | Free Speed RPM | Overall Length |                | Air Inlet (PT) | Air Hose (ID)       | Avg-Air Consumption |            | Net Weight |                                 | Packing Pcs/Ctn/G.W./Cuft (kgs) |
|              | in.                 | mm                    |                | in.            | mm             |                |                     | CFM                 | l/min      | lbs        | kgs.                            |                                 |
| AT-6034E     | 7/16"               | 111                   | 2,500          | 8 7/8"         | 225            | 1/4"           | 3/8"                | 4.0                 | 113.0      | 2.2        | 1.0                             | 10/Ctn/12.0/1.0'                |
| AT-6055      | 2 1/2"              | 64                    | 2,500          | 8 3/5"         | 220            | 1/4"           | 3/8"                | 4.0                 | 113.0      | 2.4        | 1.1                             | 20/Ctn/21.0/1.29'               |
| AT-6056E     | 7/16"               | 111                   | 2,500          | 8 1/3"         | 210            | 1/4"           | 3/8"                | 4.0                 | 113.0      | 2.2        | 1.0                             | 10/Ctn/12.0/1.0'                |
| AT-6056A     | 7/16"               | 111                   | 2,500          | 8 7/8"         | 225            | 1/4"           | 3/8"                | 3.0                 | 85.0       | 2.2        | 1.0                             | 20/Ctn/23.0/0.7'                |
| Model No.    | Capacity            |                       | Overall Length |                | Air Inlet (PT) | Air Hose (ID)  | Avg-Air Consumption |                     | Net Weight |            | Packing Pcs/Ctn/G.W./Cuft (kgs) |                                 |
|              | in.                 | mm                    | in.            | mm             |                |                | CFM                 | l/min               | lbs        | kgs.       |                                 |                                 |
| AT-6040      | 9"                  | 310                   | 12"            | 305            | 1/4"           | 3/8"           | 4.0                 | 113.0               | 5.3        | 2.4        | 10/Ctn/12.0/1.0'                |                                 |
| AT-2032M-13  | 13"                 | 500                   | 13 1/4"        | 336            | 1/4"           | 3/8"           | 0.1                 | 2.8                 | 2.6        | 1.2        | 10/Ctn/15.0/2.9'                |                                 |
| AT-2033MC-13 | 13"                 | 500                   | 13 1/4"        | 336            | 1/4"           | 3/8"           | 0.1                 | 2.8                 | 3.0        | 1.4        | 10/Ctn/15.0/2.9'                |                                 |





**AT-2252M**  
Dual Component Caulking Gun  
- CAPACITY GLUE: 390ML



**AT-2253M**  
Dual Component Caulking Gun  
- CAPACITY GLUE: 600ML



**AT-6036**  
Grease Gun  
- CAPACITY CARTRIDGE: 14OZ (BULK: 400C.C.)



**AT-6036-6**  
Grease Gun  
- CAPACITY CARTRIDGE: 14OZ (BULK: 400C.C.)  
- W/ 6PCS ACCESSORIES

**AT-6036L**  
Grease Gun  
- CAPACITY CARTRIDGE: 16OZ (BULK: 500C.C.)

**AT-6036L-6**  
Grease Gun  
- CAPACITY CARTRIDGE: 16OZ (BULK: 500C.C.)  
- W/ 6PCS ACCESSORIES



**AT-2500A**  
Composite Needle Scaler  
- NO. OF NEEDLE: 3\*180MM x 12PCS



**AT-2168NS**  
Pistol Type Needle Scaler  
- NO. OF NEEDLE: 3\*180MM x 19PCS



**AT-2504**  
Pistol Type Needle Scaler  
- NO. OF NEEDLE: 4\*180MM x 35PCS



**AT-2505**  
Pistol Type Needle Scaler  
- NO. OF NEEDLE: 3\*180MM x 19PCS



**AT-6046**  
Mini Grease Gun  
- CAPACITY BULK: 80C.C.



**AT-6047**  
- CAPACITY CARTRIDGE: 3.5OZ



**PHS80**  
Mini Grease Gun  
- CAPACITY BULK: 10C.C.



**PHS80K**  
Mini Grease Gun Kit  
- CAPACITY BULK: 10C.C.



**AT-2720**  
Pistol Type Needle Scaler  
- NO. OF NEEDLE: 3\*180MM x 19PCS



**AT-2368NS**  
Heavy Duty Needle Scaler  
- NO. OF NEEDLE: 3\*180MM x 19PCS

| Model No. | Capacity Glue ml | Mix Ratio | Overall Length |     | Air Inlet (PT) | Air Hose (ID) | Net Weight |      | Packing Pcs/Ctn/G.W./Cuft (kgs) |
|-----------|------------------|-----------|----------------|-----|----------------|---------------|------------|------|---------------------------------|
|           |                  |           | in.            | mm  |                |               | lbs        | kgs. |                                 |
| AT-2252M  | 390              | 1:3       | 25 1/5"        | 640 | 1/4"           | 3/8"          | 4.53       | 2.06 | 5/Ctn/16.0/3.3'                 |
| AT-2253M  | 600              | 1:1       | 28 1/2"        | 725 | 1/4"           | 3/8"          | 5.0        | 2.28 | 10/Ctn/17.0/3.3'                |

| Model No. | Capacity Bulk cc | Cartridge | Input Pressure psi | Output Pressure psi | Air Inlet (PT) | Air Hose (ID) | Net Weight |      | Packing Pcs/Ctn/G.W./Cuft (kgs) |
|-----------|------------------|-----------|--------------------|---------------------|----------------|---------------|------------|------|---------------------------------|
|           |                  |           |                    |                     |                |               | lbs        | kgs. |                                 |
| AT-6036   | 400              | 14oz      | 40~150             | 1600~6000           | 1/4"           | 3/8"          | 3.5        | 1.6  | 10/Ctn/18.4/2.6'                |
| AT-6036L  | 500              | 16oz      | 40~150             | 1600~6000           | 1/4"           | 3/8"          | 3.6        | 1.65 | 10/Ctn/19.0/2.6'                |

| Model No. | no. of needle(mm) | Air Inlet (PT) | Avg-Air Consumption |       | Blow Per Min (BPM) | Sound Pressure level (dba) | Power Pressure level (dba) | Vibration level (M/sec <sup>2</sup> ) | Overall Length |     | Net Weight |      | Packing Pcs/Ctn/G.W./Cuft (kgs) |
|-----------|-------------------|----------------|---------------------|-------|--------------------|----------------------------|----------------------------|---------------------------------------|----------------|-----|------------|------|---------------------------------|
|           |                   |                | cfm                 | l/min |                    |                            |                            |                                       | in.            | mm  | lbs        | kgs. |                                 |
| AT-2500A  | 3x180mmx12Pcs     | 3/8"           | 7.1                 | 201   | 4000               | 95.8                       | 106.8                      | 3.6                                   | 13.6"          | 345 | 5.3        | 2.4  | 6/15/16/0.5'                    |
| AT-2168NS | 3x180mmx19Pcs     | 1/4"           | 15                  | 424   | 4600               | 97.09                      | 108.08                     | 7.27                                  | 18.1"          | 460 | 7          | 3.2  | 6/21/22/1.3'                    |
| AT-2504   | 4x180mmx35Pcs     | 1/4"           | 10                  | 283   | 2500               | 100.8                      | 116.8                      | 23                                    | 18.1"          | 460 | 13.2       | 6    | 4/20/22/1.8'                    |
| AT-2505   | 3x180mmx19Pcs     | 1/4"           | 10                  | 283   | 3700               | 97                         | 107.8                      | 8.7                                   | 13"            | 330 | 5.9        | 2.7  | 6/18/20/1.3'                    |
| AT-2720   | 3x180mmx19Pcs     | 1/4"           | 10                  | 283   | 3000               | 96.82                      | 107.81                     | 17.25                                 | 14.5"          | 370 | 5.9        | 2.7  | 6/18/19/1.3'                    |
| AT-2368NS | 3x180mmx19Pcs     | 1/4"           | 15                  | 424   | 4600               | 96.76                      | 107.75                     | 5.87                                  | 21.2"          | 540 | 7.3        | 3.3  | 6/21.5/22.5/1.3'                |



**Abrasive Grit Size**

Ultra Fine Sanding (500 +Grit generally)



3/32" (2.5mm)

General Sanding (120~400 Grit generally)



3/16" (5.0mm)

Aggressive Sanding (under 120 Grit generally)



3/8" (9.5mm)

**Oil Series - General type**

| Model No.                | AE3600-N3  | AE3600-C3      | AE3600-S3           |
|--------------------------|------------|----------------|---------------------|
| Pad Dia / In.(mm)        | 3"(75)     | 3"(75)         | 3"(75)              |
| Free Speed RPM           | 11,000     | 11,000         | 11,000              |
| Orbit Dia / In.(mm)      |            |                |                     |
| Avg.Air Cons. / CFM      | 11         | 11             | 11                  |
| Net Weight / Kg.(Lbs)    | 0.8 (1.8)  | 0.8 (1.8)      | 0.8 (1.8)           |
| Air Inlet / In.          | 1/4"       | 1/4"           | 1/4"                |
| Min. Hose Size / In.(mm) | 3/8"(10)   | 3/8"(10)       | 3/8"(10)            |
| Type of Tool             | Non-Vacuum | Central-Vacuum | Self-Generated-Vac. |



| Model No.                | AE600-N5/N6       | AE600-C5/C6       | AE600-S5/S6         |
|--------------------------|-------------------|-------------------|---------------------|
| Pad Dia / In.(mm)        | 5"(125) / 6"(150) | 5"(125) / 6"(150) | 5"(125) / 6"(150)   |
| Free Speed RPM           | 11,000            | 11,000            | 11,000              |
| Orbit Dia / In.(mm)      |                   |                   |                     |
| Avg.Air Cons. / CFM      | 11                | 11                | 11                  |
| Net Weight / Kg.(Lbs)    | 0.9 (2)           | 0.9 (2)           | 0.9 (2)             |
| Air Inlet / In.          | 1/4"              | 1/4"              | 1/4"                |
| Min. Hose Size / In.(mm) | 3/8"(10)          | 3/8"(10)          | 3/8"(10)            |
| Type of Tool             | Non-Vacuum        | Central-Vacuum    | Self-Generated-Vac. |



| Model No.                | OBS-N5/N6         | OBS-C5/C6         | OBS-S5/S6           |
|--------------------------|-------------------|-------------------|---------------------|
| Pad Dia / In.(mm)        | 5"(125) / 6"(150) | 5"(125) / 6"(150) | 5"(125) / 6"(150)   |
| Free Speed RPM           | 11,000            | 11,000            | 11,000              |
| Orbit Dia / In.(mm)      |                   |                   |                     |
| Avg.Air Cons. / CFM      | 11                | 11                | 11                  |
| Net Weight / Kg.(Lbs)    | 0.9 (2)           | 0.9 (2)           | 0.9 (2)             |
| Air Inlet / In.          | 1/4"              | 1/4"              | 1/4"                |
| Min. Hose Size / In.(mm) | 3/8"(10)          | 3/8"(10)          | 3/8"(10)            |
| Type of Tool             | Non-Vacuum        | Central-Vacuum    | Self-Generated-Vac. |



| Model No.                | E-5N/6N           | E-5C/6C           | E-5S/6S             |
|--------------------------|-------------------|-------------------|---------------------|
| Pad Dia / In.(mm)        | 5"(125) / 6"(150) | 5"(125) / 6"(150) | 5"(125) / 6"(150)   |
| Free Speed RPM           | 11,000            | 11,000            | 11,000              |
| Orbit Dia / In.(mm)      |                   |                   |                     |
| Avg.Air Cons. / CFM      | 11                | 11                | 11                  |
| Net Weight / Kg.(Lbs)    | 0.9 (2)           | 0.9 (2)           | 0.9 (2)             |
| Air Inlet / In.          | 1/4"              | 1/4"              | 1/4"                |
| Min. Hose Size / In.(mm) | 3/8"(10)          | 3/8"(10)          | 3/8"(10)            |
| Type of Tool             | Non-Vacuum        | Central-Vacuum    | Self-Generated-Vac. |

**Oil Series - 3 in 1 type**

| Model No.                | WBS2-5PF/5P/5PR | WBS2-6PF/6P/6PR |
|--------------------------|-----------------|-----------------|
| Pad Dia / In.(mm)        | 5"(125)         | 6"(150)         |
| Free Speed RPM           | 11,000          | 11,000          |
| Orbit Dia / In.(mm)      |                 |                 |
| Avg.Air Cons. / CFM      | 7               | 7               |
| Net Weight / Kg.(Lbs)    | 0.8 (1.8)       | 0.8 (1.8)       |
| Air Inlet / In.          | 1/4"            | 1/4"            |
| Min. Hose Size / In.(mm) | 3/8"(10)        | 3/8"(10)        |
| Type of Tool             | 3 in 1 type     | 3 in 1 type     |

**Oil-free Series**

| Model No.                | WBS3-3NF/3N/3NR | WBS3-3CF/3C    | WBS3-3SF/3S         |
|--------------------------|-----------------|----------------|---------------------|
| Pad Dia / In.(mm)        | 3"(75)          | 3"(75)         | 3"(75)              |
| Free Speed RPM           | 12,000          | 12,000         | 12,000              |
| Orbit Dia / In.(mm)      |                 |                |                     |
| Avg.Air Cons. / CFM      | 6               | 6              | 6                   |
| Net Weight / Kg.(Lbs)    | 0.7 (1.5)       | 0.7 (1.5)      | 0.7 (1.5)           |
| Air Inlet / In.          | 1/4"            | 1/4"           | 1/4"                |
| Min. Hose Size / In.(mm) | 3/8"(10)        | 3/8"(10)       | 3/8"(10)            |
| Type of Tool             | Non-Vacuum      | Central-Vacuum | Self-Generated-Vac. |



| Model No.                | WBS3-5NF/5N/5NR | WBS3-5CF/5C/5CR | WBS3-5SF/5S/5SR     |
|--------------------------|-----------------|-----------------|---------------------|
| Pad Dia / In.(mm)        | 5"(125)         | 5"(125)         | 5"(125)             |
| Free Speed RPM           | 12,000          | 12,000          | 12,000              |
| Orbit Dia / In.(mm)      |                 |                 |                     |
| Avg.Air Cons. / CFM      | 6               | 6               | 6                   |
| Net Weight / Kg.(Lbs)    | 0.8 (1.8)       | 0.8 (1.8)       | 0.8 (1.8)           |
| Air Inlet / In.          | 1/4"            | 1/4"            | 1/4"                |
| Min. Hose Size / In.(mm) | 3/8"(10)        | 3/8"(10)        | 3/8"(10)            |
| Type of Tool             | Non-Vacuum      | Central-Vacuum  | Self-Generated-Vac. |



| Model No.                | WBS3-6NF/6N/6NR | WBS3-6CF/6C/6CR | WBS3-6SF/6S/6SR     |
|--------------------------|-----------------|-----------------|---------------------|
| Pad Dia / In.(mm)        | 6"(150)         | 6"(150)         | 6"(150)             |
| Free Speed RPM           | 12,000          | 12,000          | 12,000              |
| Orbit Dia / In.(mm)      |                 |                 |                     |
| Avg.Air Cons. / CFM      | 6               | 6               | 6                   |
| Net Weight / Kg.(Lbs)    | 0.8 (1.8)       | 0.8 (1.8)       | 0.8 (1.8)           |
| Air Inlet / In.          | 1/4"            | 1/4"            | 1/4"                |
| Min. Hose Size / In.(mm) | 3/8"(10)        | 3/8"(10)        | 3/8"(10)            |
| Type of Tool             | Non-Vacuum      | Central-Vacuum  | Self-Generated-Vac. |

**Oil-free Series - 3 in 1 type**

| Model No.                | WBS1-5PF/5P/5PR | WBS1-6PF/6P/6PR |
|--------------------------|-----------------|-----------------|
| Pad Dia / In.(mm)        | 5"(125)         | 6"(150)         |
| Free Speed RPM           | 11,000          | 11,000          |
| Orbit Dia / In.(mm)      |                 |                 |
| Avg.Air Cons. / CFM      | 7               | 7               |
| Net Weight / Kg.(Lbs)    | 0.7 (1.5)       | 0.7 (1.5)       |
| Air Inlet / In.          | 1/4"            | 1/4"            |
| Min. Hose Size / In.(mm) | 3/8"(10)        | 3/8"(10)        |
| Type of Tool             | 3 in 1 type     | 3 in 1 type     |

